



## Osiers Road, SW18

£500,000

This stylish apartment is on the fifth floor of a modern block built by Taylor Wimpey in 2007. The flat has two bedrooms, a balcony, a 150 year lease from 2005 and secure underground parking.

Point Pleasant is located moments from the River Thames, at the UberBoat 'Riverside Quarter' stop. On the edge of Wandsworth Park, it is within walking distance from both Putney and Wandsworth High Streets with their many amenities, shops, restaurants, coffee shops, supermarkets and Shopping Centres. East Putney Tube and Wandsworth Town station are both within walking distance giving both overground and underground access to Central London, as well as being on many bus routes.

The Roche School (nursery and primary) is on the doorstep and Brandlehow Primary School is also nearby

### Features

- Modern Flat
- Parking
- Two Bedrooms
- One Bathroom
- Balcony
- Communal Gardens

# Osiers Road, London, SW18

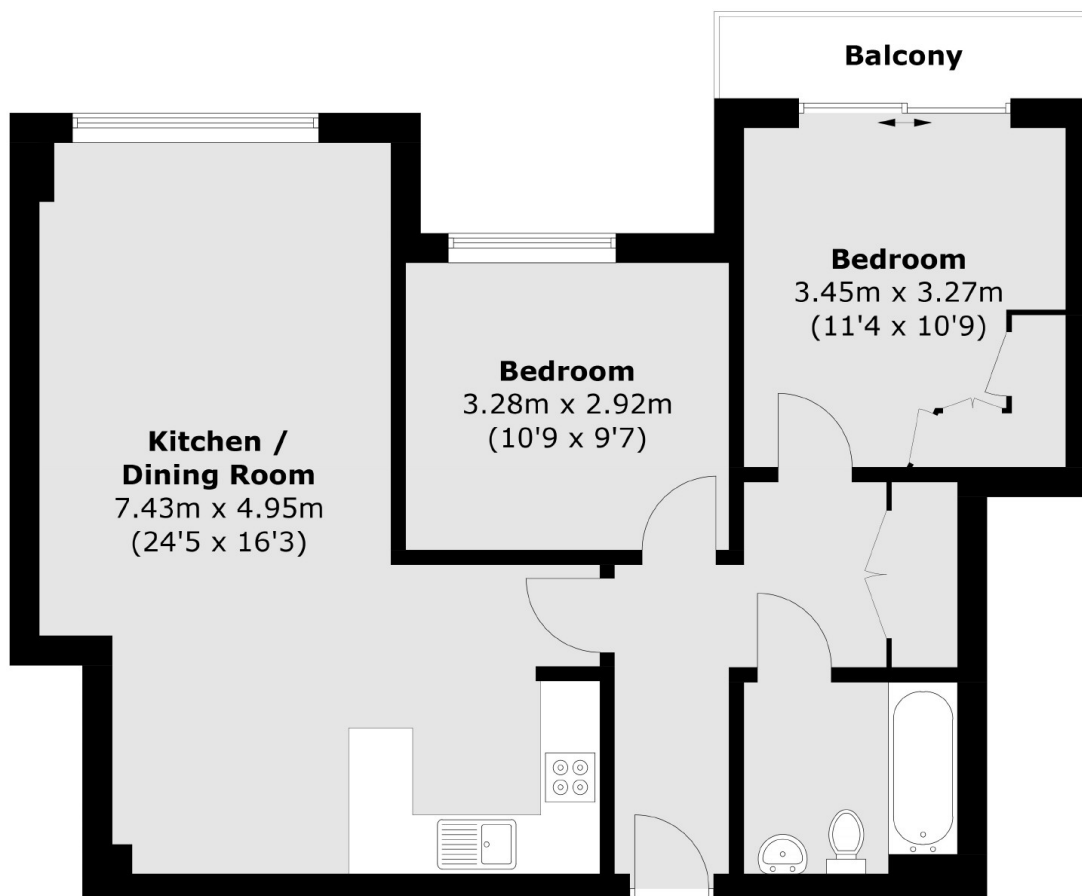

Total area (approx.): 67.6 sq. m (727.6 sq. ft)  
Balcony area (approx.): 3.1 sq. m (33.4 sq. ft)