



Enterprise Way, SW18

£600,000

Built in 2013 by Taylor Wimpey as part of the Riverside Quarter Development, this two bedroom, one bathroom apartment has a 125 year lease from 2009, secure underground parking and scenic views to the City.

Kennet house sits just a stone's throw away from the picturesque River Thames, conveniently located at the UberBoat 'Riverside Quarter' stop. Nestled on the periphery of Wandsworth Park, it boasts easy access to the bustling Putney and Wandsworth High Streets, teeming with a plethora of amenities including shops, eateries, cafes, supermarkets, and shopping centers. Commuting is a breeze with East Putney Tube and Wandsworth Town station within walking distance, offering seamless connections to both overground and underground services to Central London, in addition to being serviced by numerous bus routes.

For families, educational options abound with The Roche School (offering nursery and primary education) right at the doorstep, while Brandlehow Primary School is also conveniently nearby.

Features

- Modern Flat
- Parking
- Two Bedrooms
- One Bathroom
- Balcony
- Great Location

Enterprise Way, London, SW18

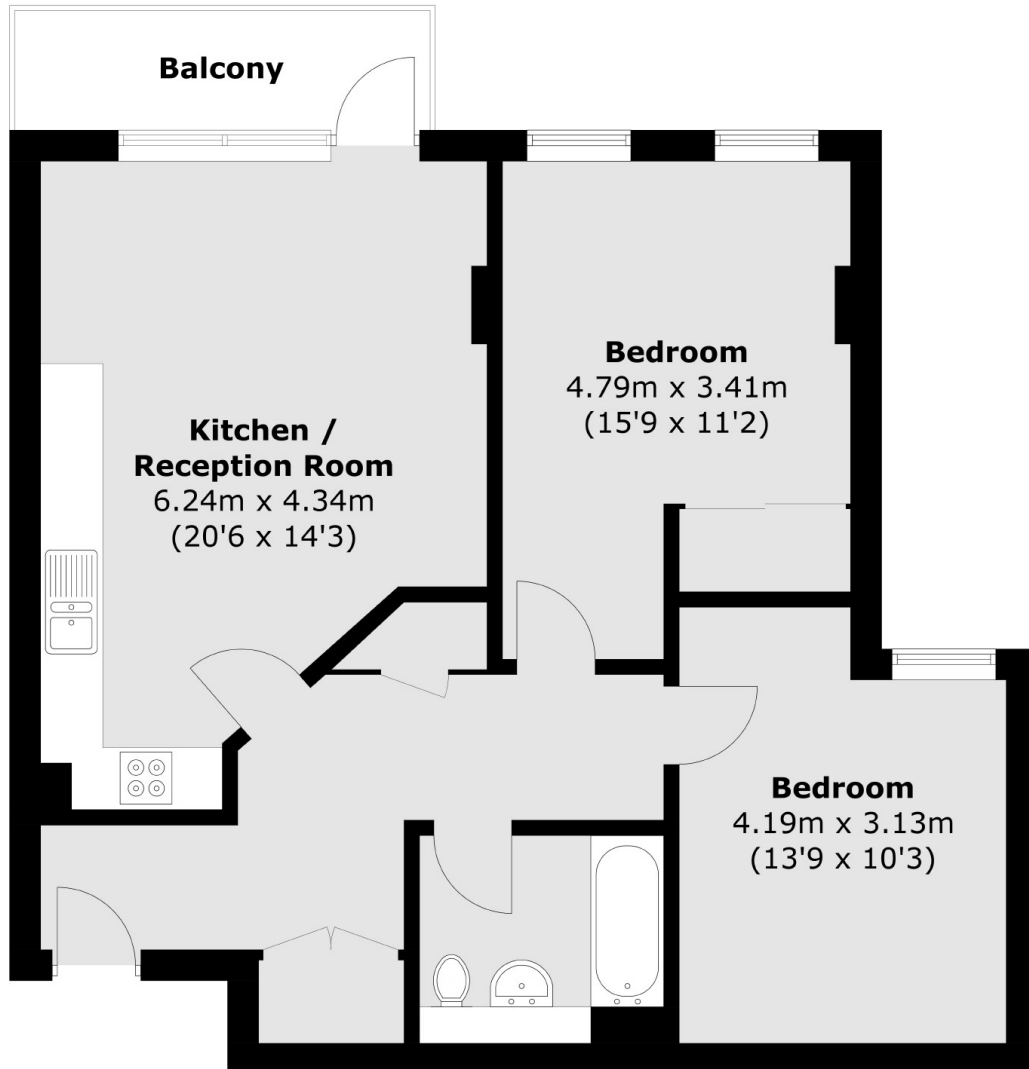

Total area (approx.): 69.9 sq. m (752.4 sq. ft)
Balcony area : 4.6 sq. m (49.5 sq. ft)