



Eastfields Avenue, SW18

£400,000

Positioned on the fifth floor, this high specification apartment offers excellent storage solutions. The kitchen seamlessly integrates with the open-plan living area, featuring elegant wooden floors. Eastfields Avenue presents a wealth of amenities, including a concierge service, two private gyms, a swimming pool, sauna, and steam room.

Situated in Wandsworth Borough, residents enjoy the advantage of low taxes. The nearest rail station is Wandsworth Town, with Putney also in close proximity. East Putney tube station, serving the District line, is conveniently nearby. Additionally, the development hosts various shops for added convenience, such as a grocery store and coffee shop. Wandsworth Park, offering a peaceful retreat for outdoor leisure activities, is just around the corner.

Features

- One Bedroom
- Fifth Floor
- Gym
- Concierge
- Swimming Pool
- 999 Year Lease

Eastfields Avenue, London, SW18

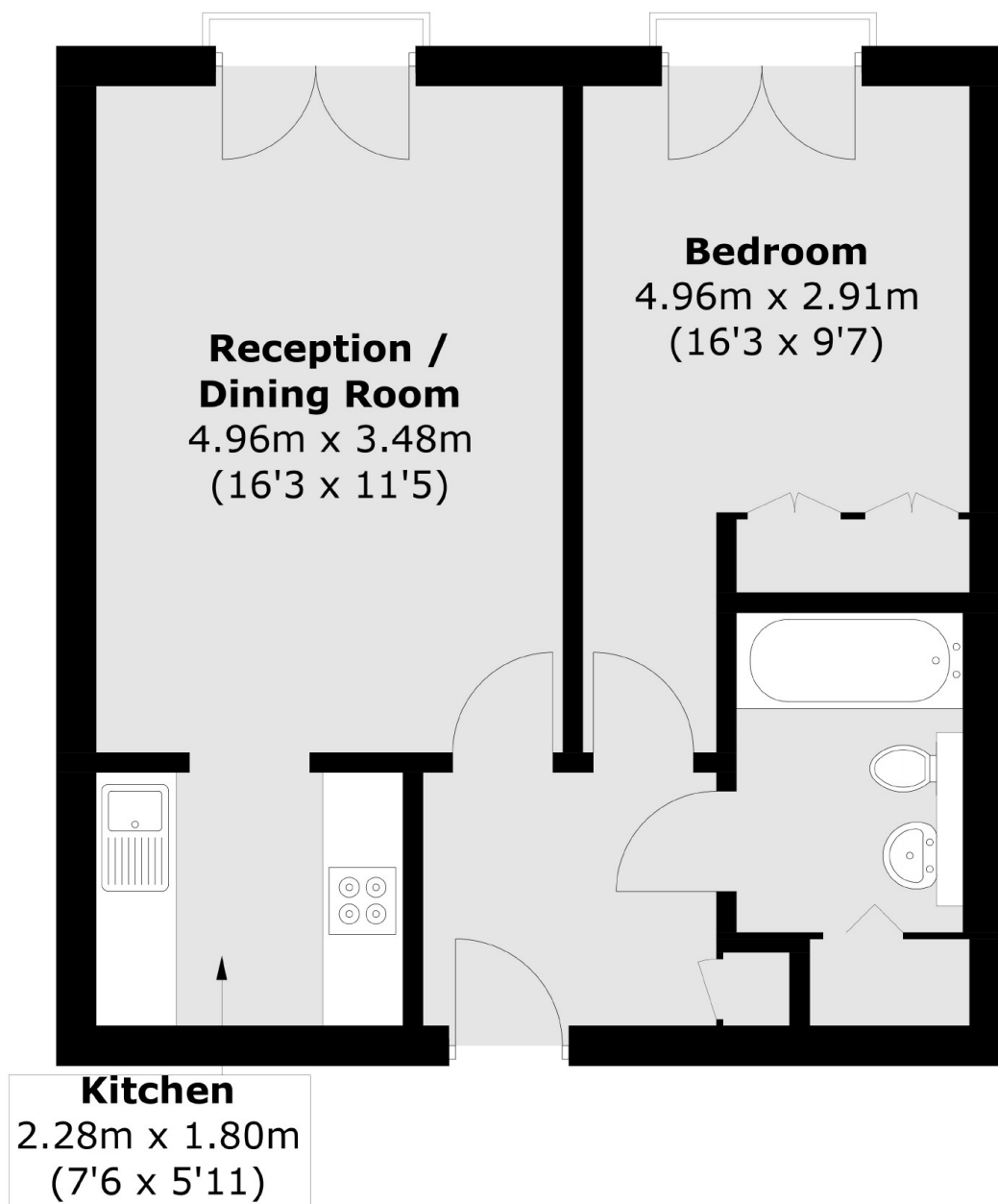

Total area (approx.): 46.8 sq. m (503.7 sq. ft)