



Drapers Yard, SW18

£450,000

This modern flat was built in 2018 by leading global developer Greenland and has a 999 year lease. The flat has floor-to-ceiling windows, zoned underfloor heating, one bedroom, a bathroom and an open-plan handleless kitchen with a quartz worktop.

The flat is close to Wandsworth Town Station (Rail) and Wandsworth Riverside Quarter Pier (Riverboat). See the developemnt website for more information: <https://ramquarter.com/local-area/>

2021 Winner of British Homes Awards: "Best Mixed-Use Development Of The Year".

Features

Stylish and contemporary throughout
Open plan entertaining and living space
Westerly facing with floor to ceiling windows
Integrated Siemens appliances
24 hour concierge
Prime location near Wandsworth Town Station with easy links into central London

Drapers Yard, London, SW18

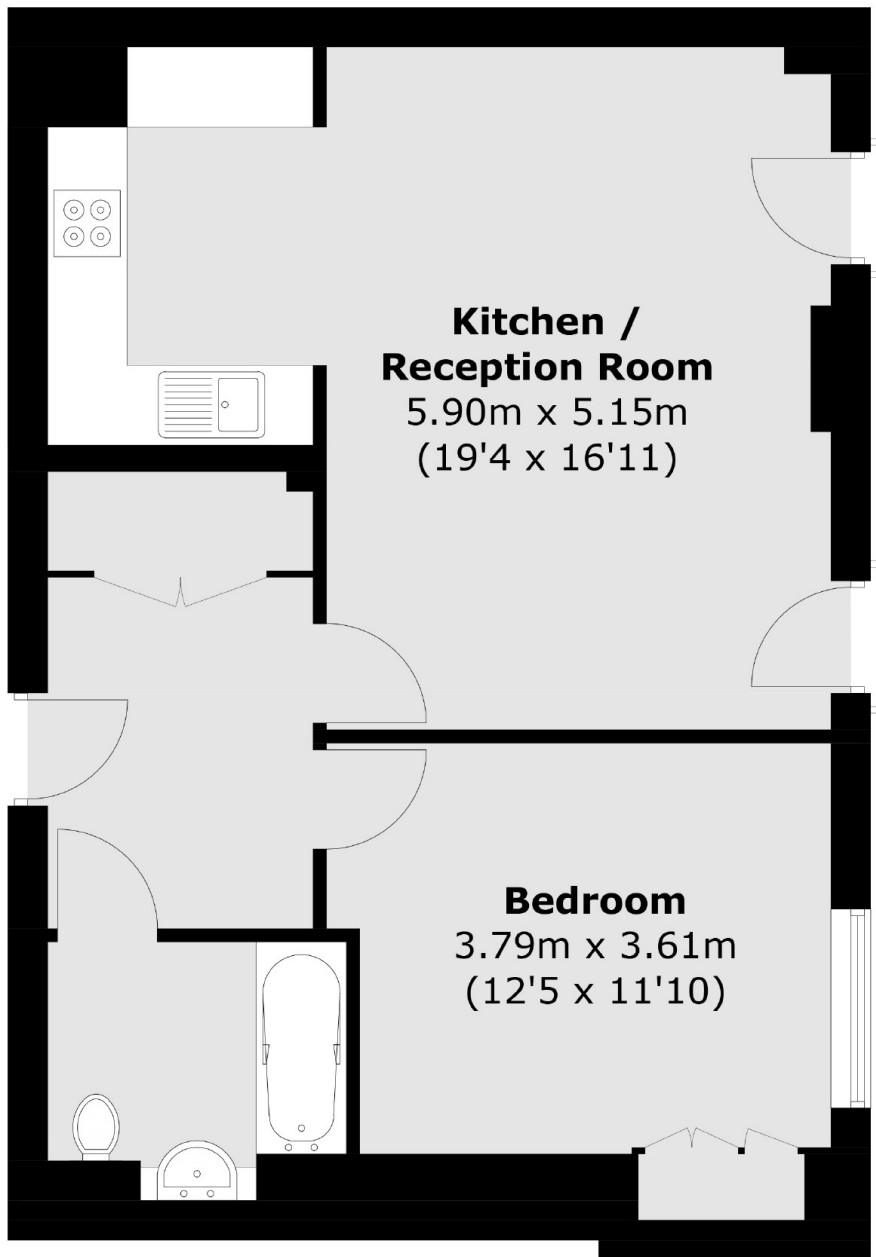

Total area (approx.): 50.4 sq. m (542.5 sq. ft)

Dexters

Putney
176 Putney High Street
London
SW15 1RS

Sales
020 8789 9999

Energy Rating: B. We aim to make our particulars both accurate and reliable. However they are not guaranteed; nor do they form part of an offer or contract. If you require clarification on any points then please contact us, especially if you're traveling some distance to view. Please note that appliances and heating systems have not been tested and therefore no warranties can be given as to their good working order.

 **RICS** | Regulated
Estate Agent
and Letting Agent

dexters.co.uk