



Putney Bridge Road, SW18

£600,000

This freehold Victorian cottage with two bedrooms is close to Wandsworth Town. Part of a small cul-de-sac with just four houses, the house is unmodernised but has the potential to extend (subject to planning) and a good size garden. We understand that the house is in a conservation area.

Bush Cottages is really close to Wandsworth Town and East Putney. Wandsworth Park is just up the road alongside the river Thames. Southside Shopping centre is just over the road and has plenty of gyms, cafés, shops and restaurants.

Features

- Freehold
- Victorian House
- Two Bedrooms
- Garden
- Unmodernised
- Great Location

Putney Bridge Road, London, SW18

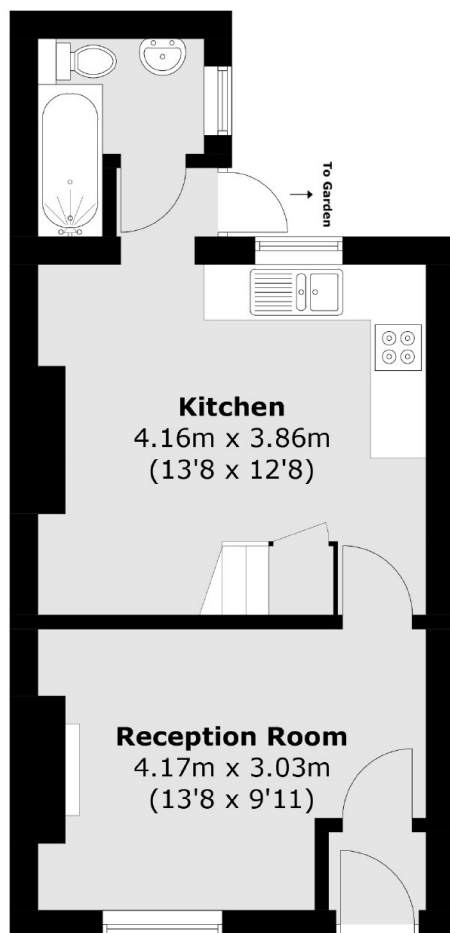

Ground Floor

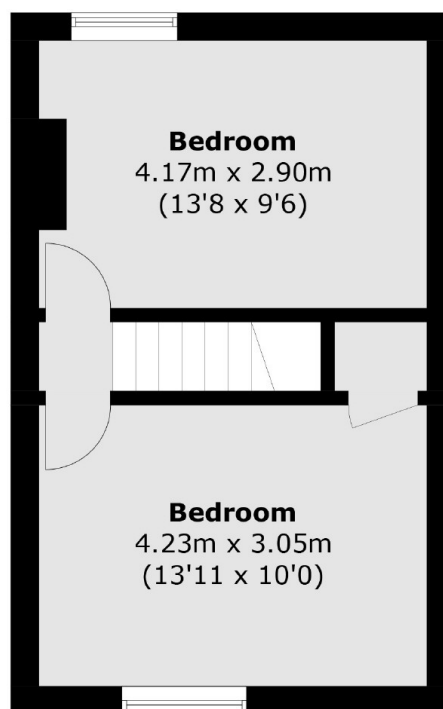

First Floor

Total area (approx.): 63.4 sq. m (682.4 sq. ft)