



Heath Rise, SW15

£1,225,000

Dexters



Heath Rise, SW15

This five bedroom ground floor apartment has been renovated recently and now displays the parquet original floors at their best. Heath Rise a landmark period development of Art Deco flats in its own gated grounds just off Putney Hill. This flat has a share of the freehold, a 999 year lease, a garage and tennis courts.

Heath Rise is on Kersfield Road, just off Putney Hill. This location gives excellent access to Putney mainline train station, the High Street and major bus routes. The A3 provides easy access to routes in and out of London.

Features

- Ground Floor
- Garage
- Art Deco
- 192sq.m
- Share Of Freehold
- Tennis Court







Heath Rise, London, SW15

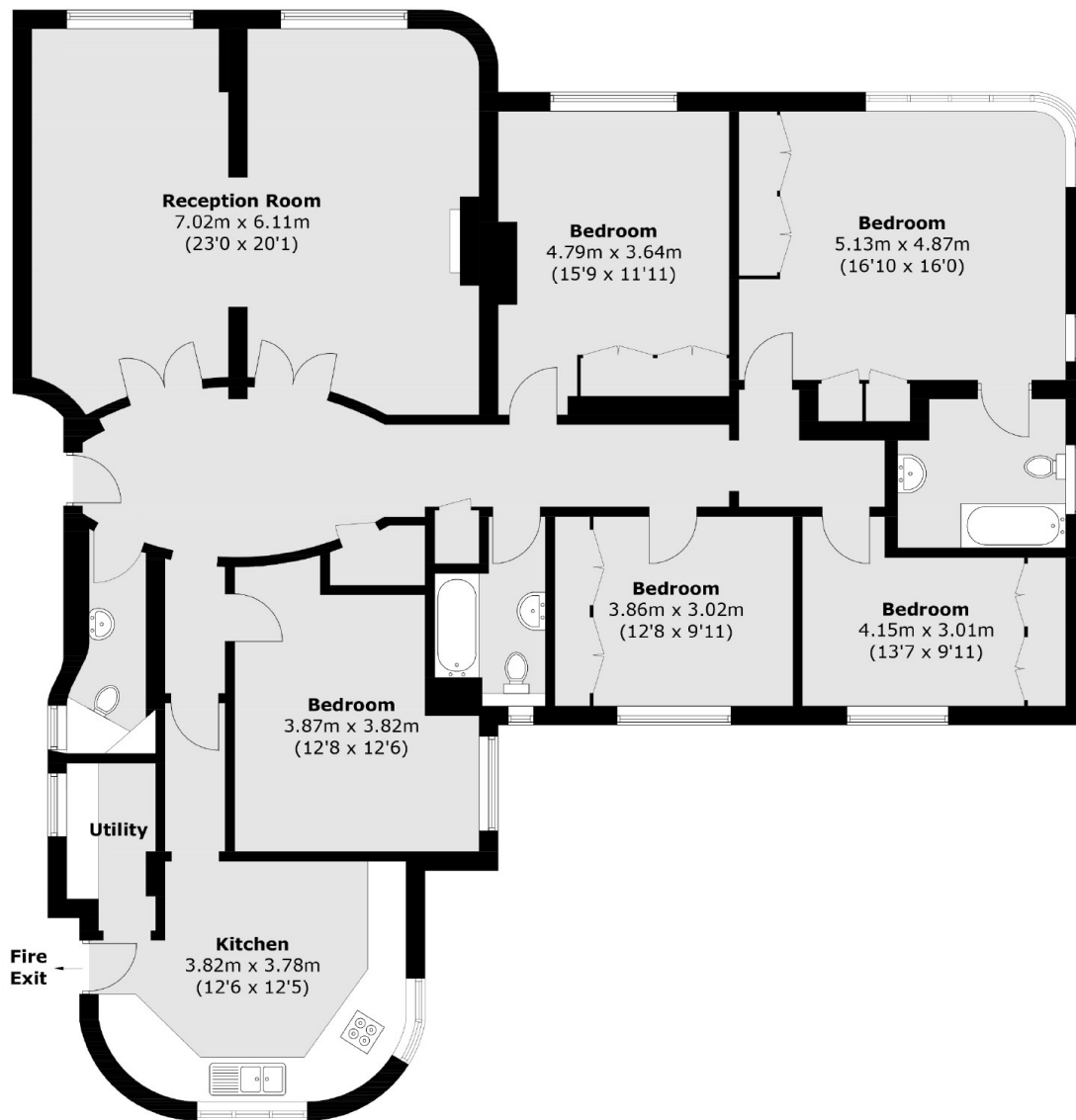

Total area (approx.): 191.9 sq. m (2065.6 sq. ft)