



## Bishops Hall, KT1

### £400,000

A beautifully presented one bedroom apartment ideally positioned between Kingston Market Place and the River Thames, in the heart of Kingston. Completed in 2021, this highly sought after development enjoys a prime location within easy walking distance of the town centre's extensive shops, restaurants and transport links. Internally, the apartment is finished to an excellent standard throughout, featuring a sleek, contemporary fitted kitchen and a private balcony accessed from the living area.

Bodman House is exceptionally well located, just moments from the River Thames and the historic Kingston Market Place. John Lewis, along with a wide selection of local shops, bars and riverside restaurants, are all within approximately 100 yards of the apartment, placing the very best of Kingston right on your doorstep.

### Features

- Central Location
- Excellent Quality
- Bright And Spacious
- Lift Service
- Private Balcony
- Riverside Development

# Bishops Hall, Kingston Upon Thames, KT1

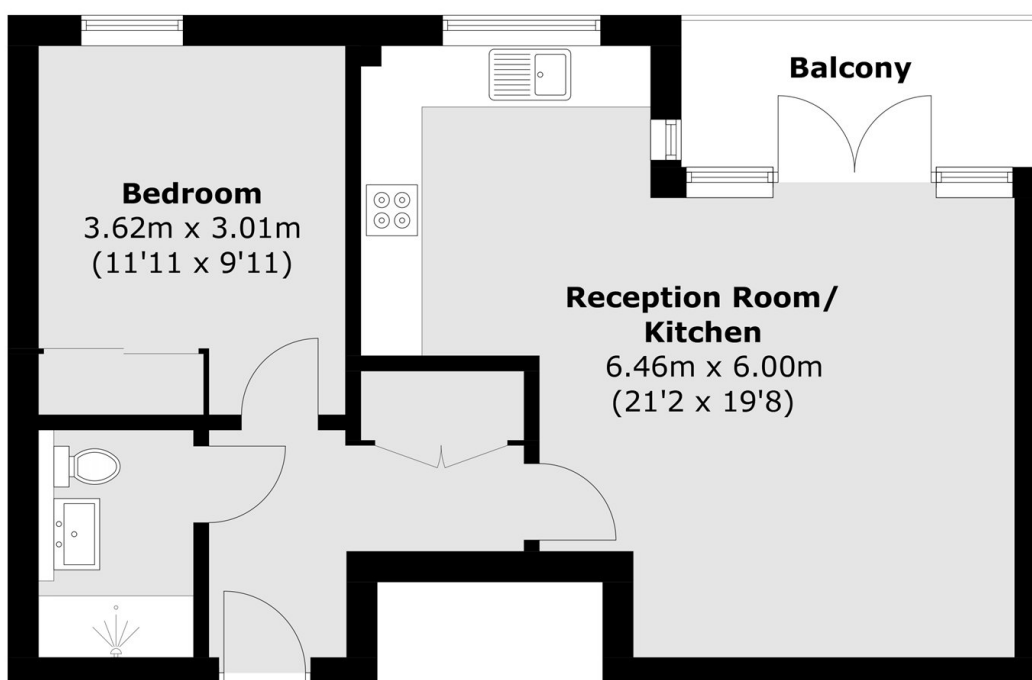

Total area (approx.): 49.5 sq. m (532.8 sq. ft)  
Balcony area: 5.0 sq. m (53.8 sq. ft)