



## Crescent Road, KT2

### £399,950

A beautifully presented, bright and spacious two double bedroom apartment, occupying the top floor of this sought after development on the highly desirable Crescent Road in Kingston. The property offers generous living space throughout, complemented by a private balcony, excellent internal storage and the added benefit of a private storage unit within the communal gardens.

Hillside Court is a lovely, low rise development just off Crescent Road and just over 500 yards to the gated of Richmond Park. Norbiton Station and local facilities are approximately half a mile away and the vibrant Kingston town centre 1 mile away.

### Features

- Two Double Bedrooms
- Top Floor
- Private Balcony
- Outside Storage Room
- Quiet Location
- Residents Permit Parking

# Crescent Road, Kingston Upon Thames, KT2

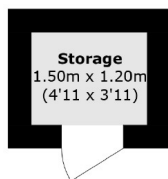

(Not shown in actual Location/Orientation)

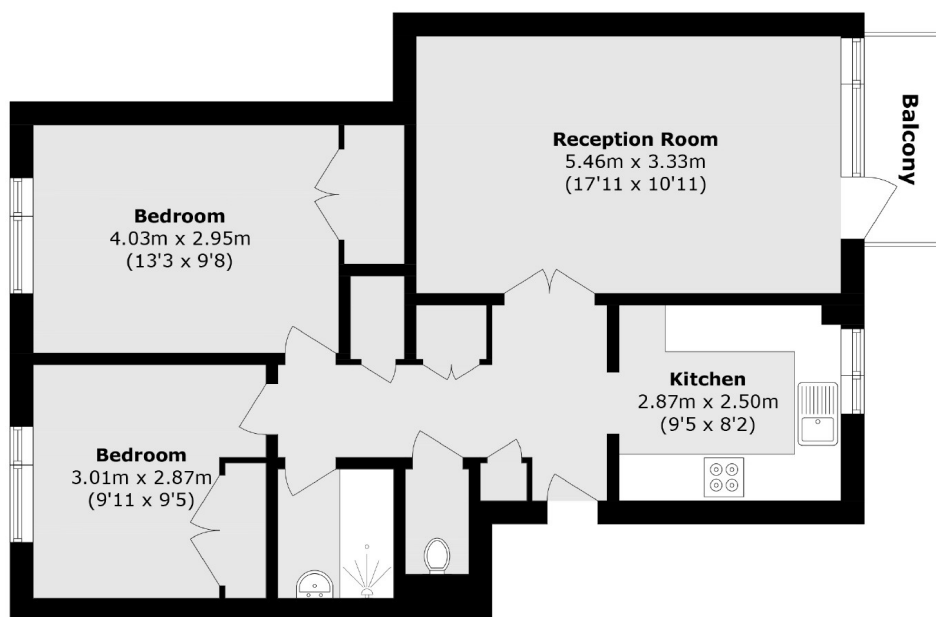

Total area (approx.): 64.1 sq. m (689.9 sq. ft)  
Balcony area (approx.): 2.7 sq. m (22.6 sq. ft)  
External Storage (approx.): 1.8 sq. m (19.3 sq. ft)