



Isabella Place, KT2

£1,525 Per calendar month

A well presented one bedroom apartment in a sought after private development. This flat is ideal for those looking for modern finishes as well as plenty of space and light! There is also allocated parking.

Isabella Place is in a sought after location within a stones throw of the River Thames, Richmond Park, Kingston and Richmond town centres with their mix of shopping, theatres and restaurants and walking distance of outstanding schools.

Features

- One Bedroom
- Modern Interiors
- High End Finish
- Allocated Parking
- North Kingston
- Wooden Flooring

Isabella Place, Kingston Upon Thames, KT2

Second Floor

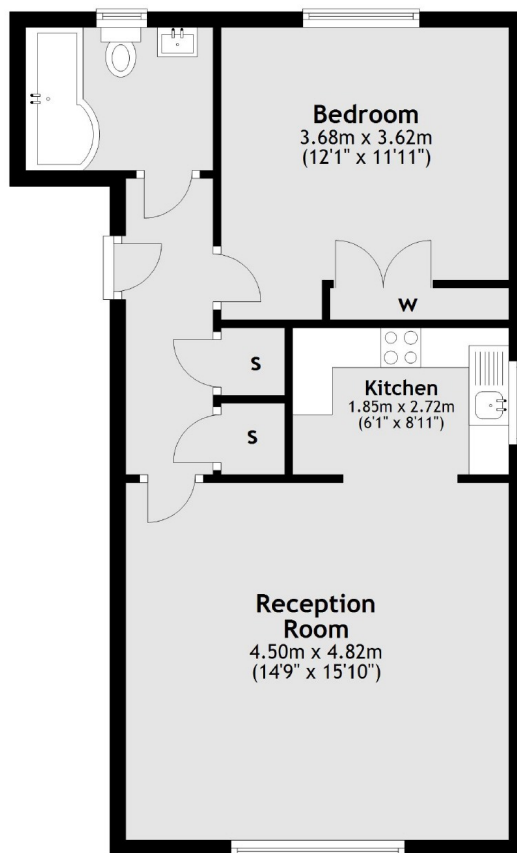

Total area: approx. 51.6 sq. metres (555.2 sq. feet)