



Isabella Place, KT2

£299,950

A larger than average, one double bedroom apartment in a sought after development in the heart of North Kingston, widely accepted as the best place to live to enjoy everything Kingston has to offer. Offered for sale with no onward chain and beautifully presented, this is a great apartment for those looking for modern property with plenty of space and light.

Isabella Place is in a sought after location off Latchmere Lane and just half a mile to the River Thames and Richmond Park. Kingston town centre is less than a mile away and there are several local outstanding schools for children of all ages.

Features

- One Double Bedroom
- Large Living Room
- Modern Kitchen
- Allocated Parking
- North Kingston
- Quiet Development

Isabella Place, Kingston Upon Thames, KT2

Second Floor

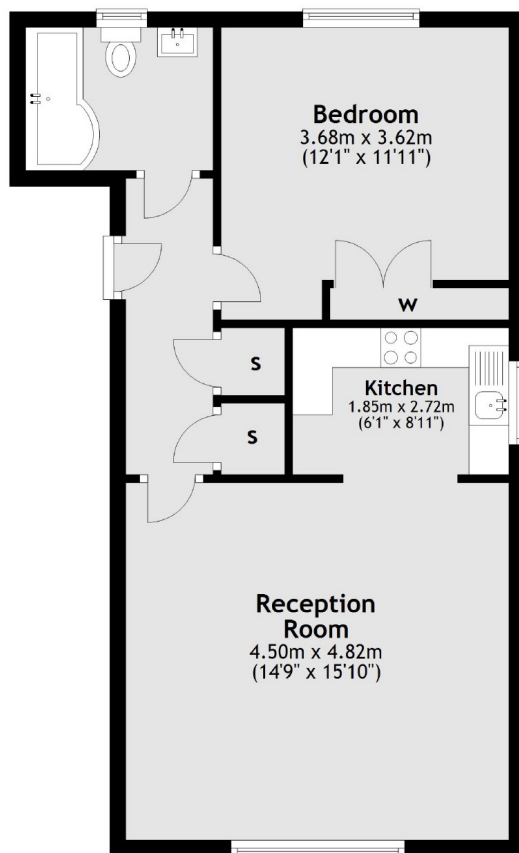

Total area: approx. 51.6 sq. metres (555.2 sq. feet)