



The Bittoms, KT1

£399,950

Located moments from the River Thames is this well presented, larger than average, two double bedroom, two bathroom apartment. The property benefits from a large principal bedroom with an en suite shower room and a lovely private balcony offering approximately 60 sq.ft of external space.

Centrally situated, Avante Court, The Bittoms, is conveniently positioned for the extensive leisure, shopping and travel amenities of Kingston Upon Thames including John Lewis, The Bentall Centre, an Ancient Market Place with artisan shops and traders, riverside bars and restaurants, theatre, cinema, Richmond Park and Kingston mainline Train Station.

Features

- Two Double Bedrooms
- Two Bathrooms
- Spacious Reception Room
- Open Plan Fitted Kitchen
- Modern Bathroom
- Secure Underground Parking

The Bittoms, Kingston Upon Thames, KT1

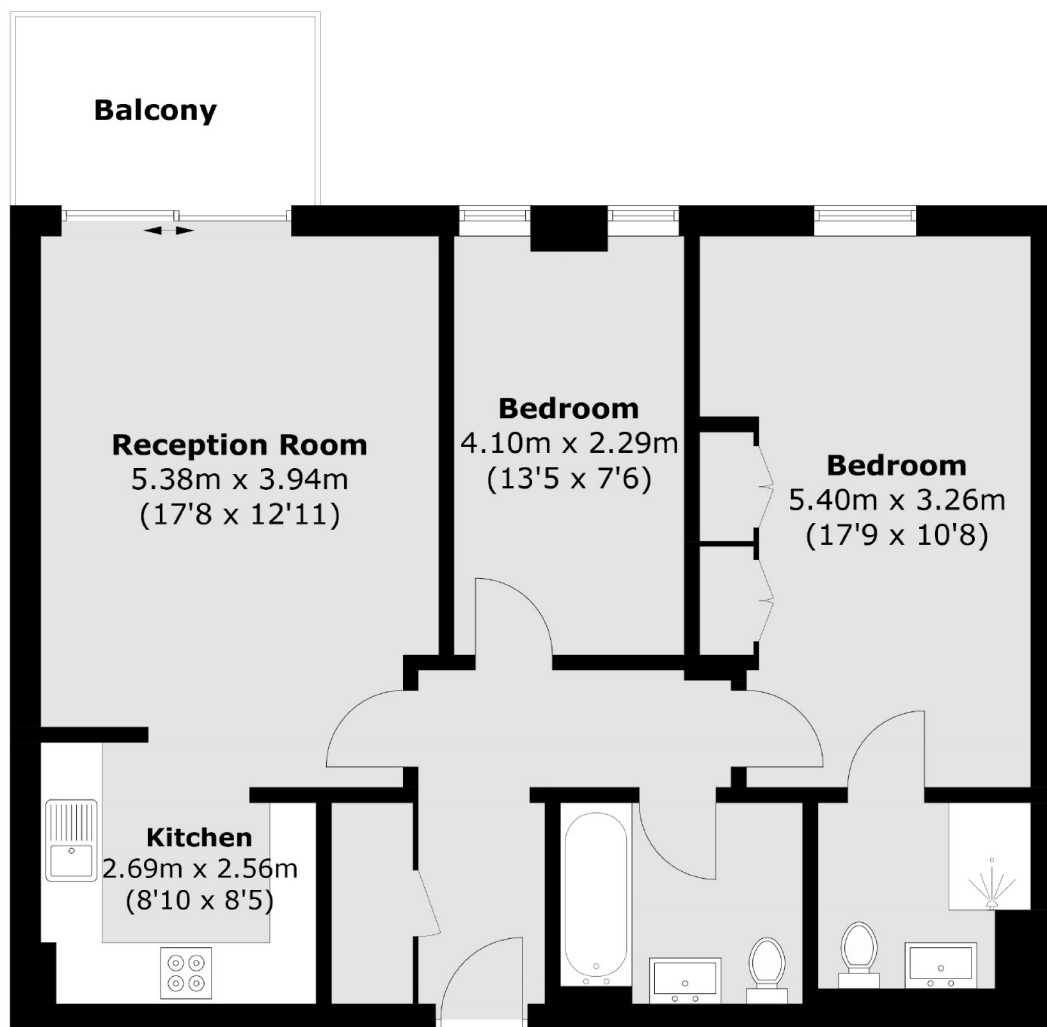

Total area (approx.): 73.2 sq. m (787.9 sq. ft)
Balcony area (approx.): 5.4 sq. m (58.1 sq. ft)