



## Tennyson Avenue, KT3

£575,000

An appealing three bedroom family home located in a highly sought-after area. This unextended, mid-terraced home, built in the 1930s, offers the potential to extend, subject to planning permission, off-street parking, a private garden and will also benefit from no onward chain.

Tennyson Avenue is a popular residential area and ideally placed just over 500 yards to Motspur Park Station and approximately one mile to Raynes Park or New Malden town centres.

### Features

- Terraced House
- Three Bedrooms
- Separate Kitchen
- Off-Street Parking
- Good Condition
- No Onward Chain



## Tennyson Avenue, KT3

The ground floor consists of a bright and spacious front reception room with a bay fronted window showcasing custom fitted plantation shutters. The kitchen/dining room has a wonderful feeling of space and has doors leading onto the rear garden.

On the first floor are the three bedrooms and family bathroom. The bedroom to the front has the advantage of the bay window, custom plantation shutters and fitted wardrobes, the other double bedroom looks onto the large private garden.

Outside to the front is a bricked driveway, which provides off-street parking. To the rear is a raised decking area, which steps down onto a generous sized garden.



# Tennyson Avenue, New Malden, KT3

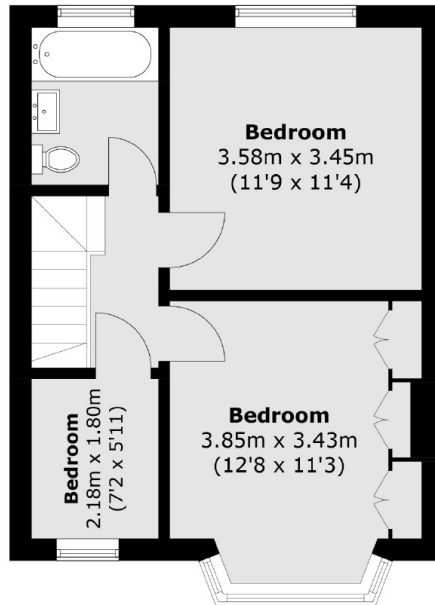

**First Floor**

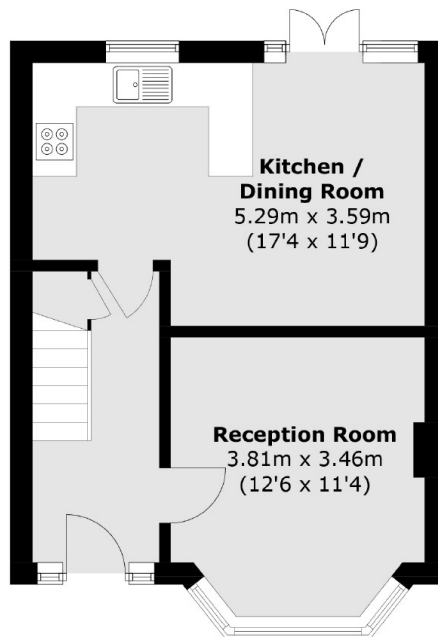

**Ground Floor**

Total area (approx.): 76.5 sq. m (823.5 sq. ft)