



Springfield Road, KT1 £235,000

A smart, top floor, one double bedroom apartment with the added benefit of a gated entrance and secure residents parking. This is a great first time purchase but would also be a super buy to let investment with its excellent location close to the town centre and local university.

Springfield Court is an attractive, private and gated development on Springfield Road, a quiet residential road less than half a mile to Kingston town centre and the banks of the River Thames.

Features

- One Double Bedroom
- Modern Bathroom
- Secure Entryphone System
- Gated Development
- Private Residents Parking
- Quiet Location

Springfield Road,
Kingston Upon Thames, KT1

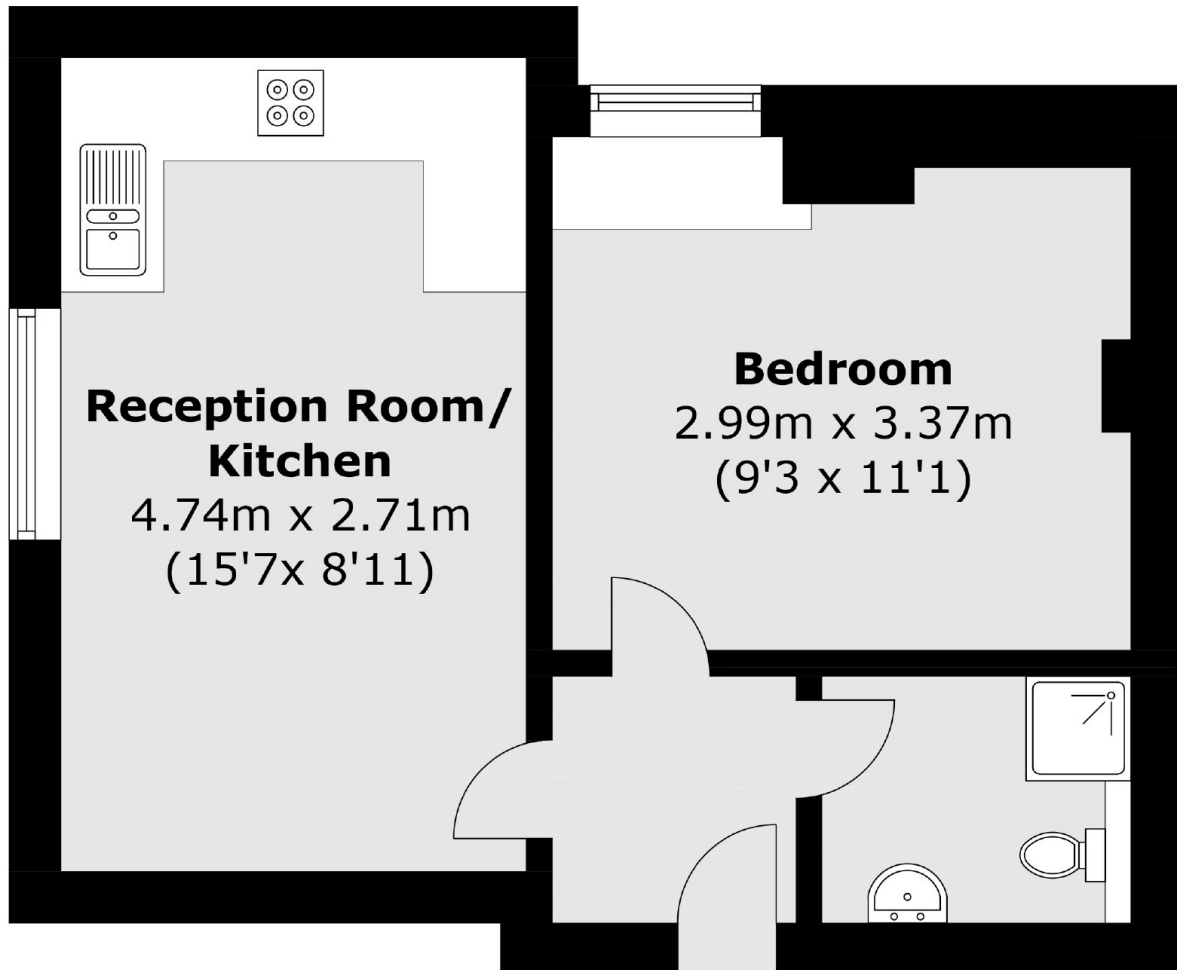

Total area (approx.): 30.1 sq. m (323.9 sq. ft)