



Cardinal Avenue, KT2

£849,950

A lovely three bedroom house that has been extended to the ground floor and now offers just under 900 sq.ft of accommodation arranged over two floors. This area is highly sought after by families due to its proximity to several excellent local schools.

Cardinal Avenue is a popular residential road situated within the highly popular Tudor Estate Development in North Kingston. The property is ideally located for the River Thames, Ham Lands and Ham Common, whilst Richmond Park offers over 2,500 acres of Royal parkland to enjoy. Access to both Richmond and Kingston centres are incredibly convenient.

Features

- Three Bedrooms
- Double Reception Room
- Fitted Kitchen
- Conservatory
- First Floor Family Bathroom
- Garden And Garage



Cardinal Avenue, KT2

The ground floor accommodation consists of an entrance hall with a staircase leading to the first floor landing, a front and rear bay double reception room with a feature fireplace, a fitted kitchen and a conservatory with uPVC French double glazed doors leading to the rear garden.

The first floor accommodation consists of a landing, a principal bay fronted double bedroom with fitted wardrobes, a second bay fronted double bedroom overlooking the garden, a single bedroom with an oriel bay window and a modern family bathroom.

The property offers the scope to extend further to the rear at ground floor level and into the loft space to create an additional double bedroom with an en suite bathroom. This is of course subject to the usual permissions.

Outside to the front is a garden. To the rear is a generous garden that is mostly laid to lawn with flower and shrub displays and a 163 sq.ft garage.



Cardinal Avenue, Kingston Upon Thames, KT2

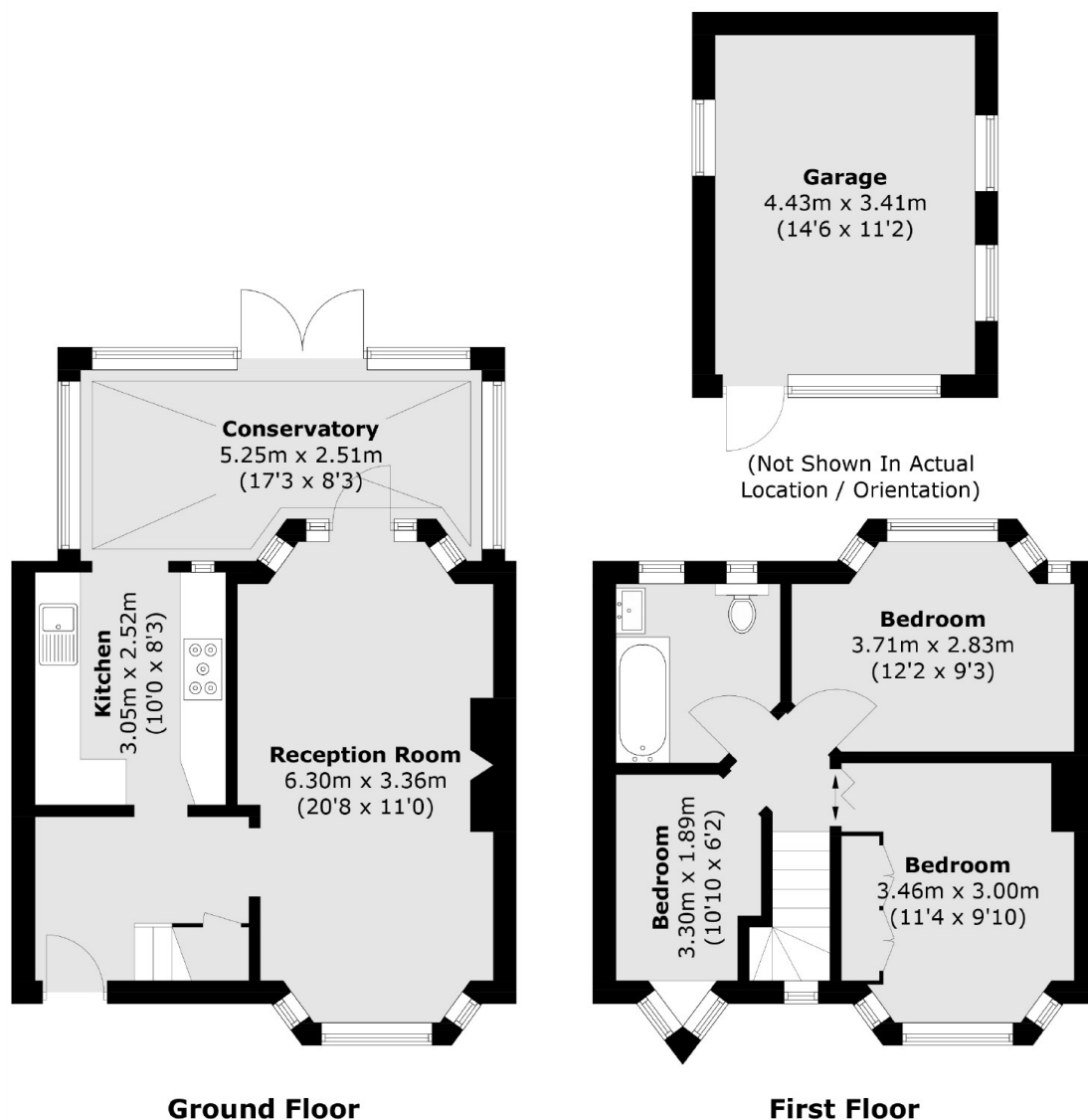

Total area (approx.): 81.2 sq. m (874.0 sq. ft)
Garage: 15.2 sq. m (163.6 sq. ft)