



## Acre Road, KT2

£310,000

A smart, one bedroom ground floor apartment centrally located for all of Kingston's main attractions including the River Thames, Richmond Park and the busy town centre. The apartment has the added benefit of a larger than average private garage, residents parking and a bright spacious interior.

The apartment is located on Acre Road, a popular residential road in North Kingston. Ideally positioned just half a mile and equidistant to Richmond Park, Kingston town centre and Canbury Gardens which leads onto the River Thames.

### Features

- One Double Bedroom
- Ground Floor
- Large Private Garage
- Residents Parking
- Central Location
- Long Lease

# Acre Road, Kingston Upon Thames, KT2

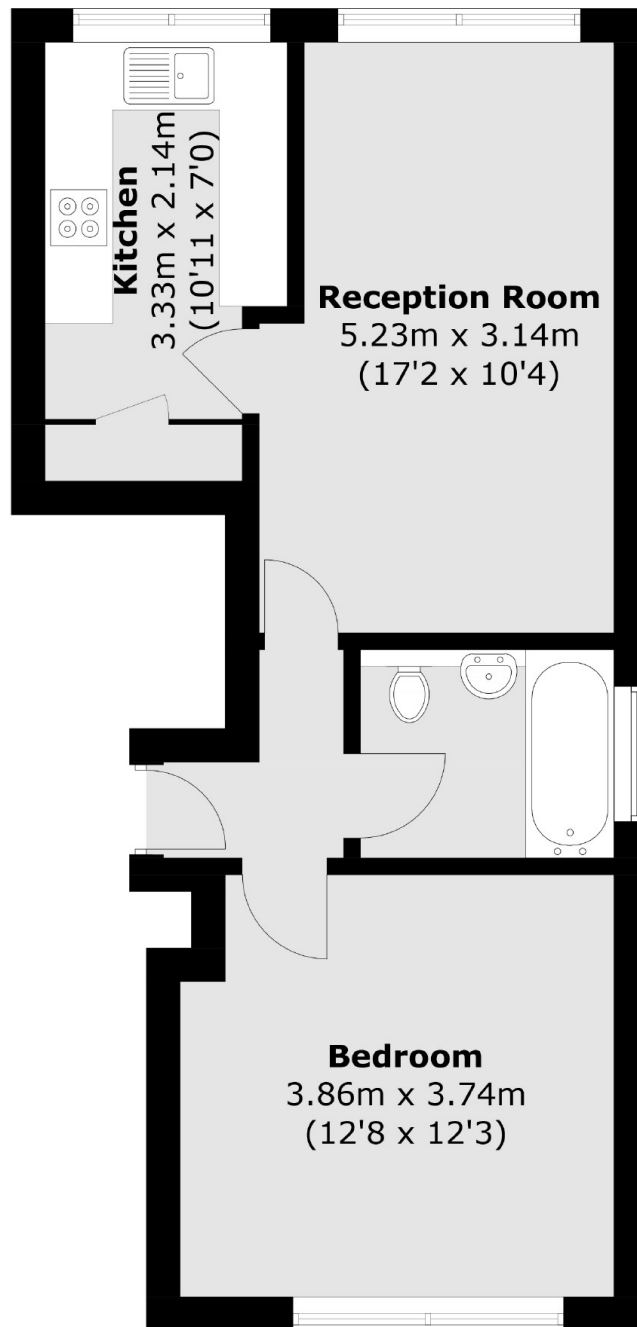

Total area (approx.): 45.7 sq. m (491.9 sq. ft)