



Richmond Road, KT2

£485,000

A perfectly placed, raised ground floor apartment with a bright and airy feel. Well presented throughout with two double bedrooms, en suite and family bathroom. This is a great apartment with private residents parking and no onward chain.

Kew Court is an attractive development perfectly positioned for Kingston town centre, just a few yards to Sainsburys and a short 500 yard stroll to Canbury Gardens and the River Thames.

Features

- Raised Ground Floor
- Two Double Bedrooms
- No Onward Chain
- Central Location
- Modern
- Gas Central Heating

Richmond Road, Kingston Upon Thames, KT2

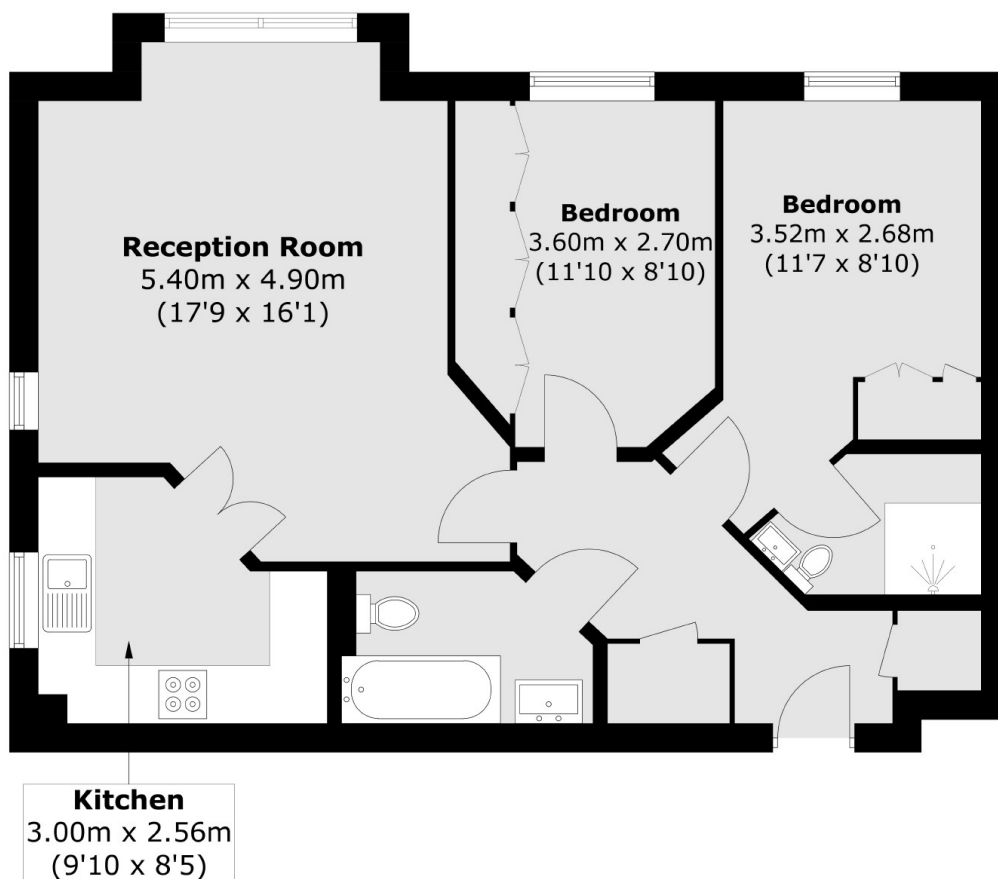

Total area (approx.): 64.7 sq. m (696.4 sq. ft)