



Royal Quarter, KT2

£350,000

A bright and spacious, one double bedroom apartment in this popular development in central Kingston. Located on the ground floor, the apartment has a private patio, is well decorated throughout, has private allocated parking, 24 hours concierge and a residents gym.

Dartmouth House is in the sought after 'Royal Quarter' development by St. George Plc. Just a couple of minutes to Kingston town centre, the mainline Station and comprehensive shopping facilities including a selection of large department stores and a daily market. The Royal Borough is well known for it's educational facilities while nearby recreational pursuits include River Thames, Canbury Gardens, Richmond Park and a choice of riverside bars/restaurants.

Features

- One Double Bedrooms
- Ground Floor
- Direct Access To A Terrace
- Secure Gated Development
- Concierge
- No Onward Chain

Royal Quarter, Kingston Upon Thames, KT2

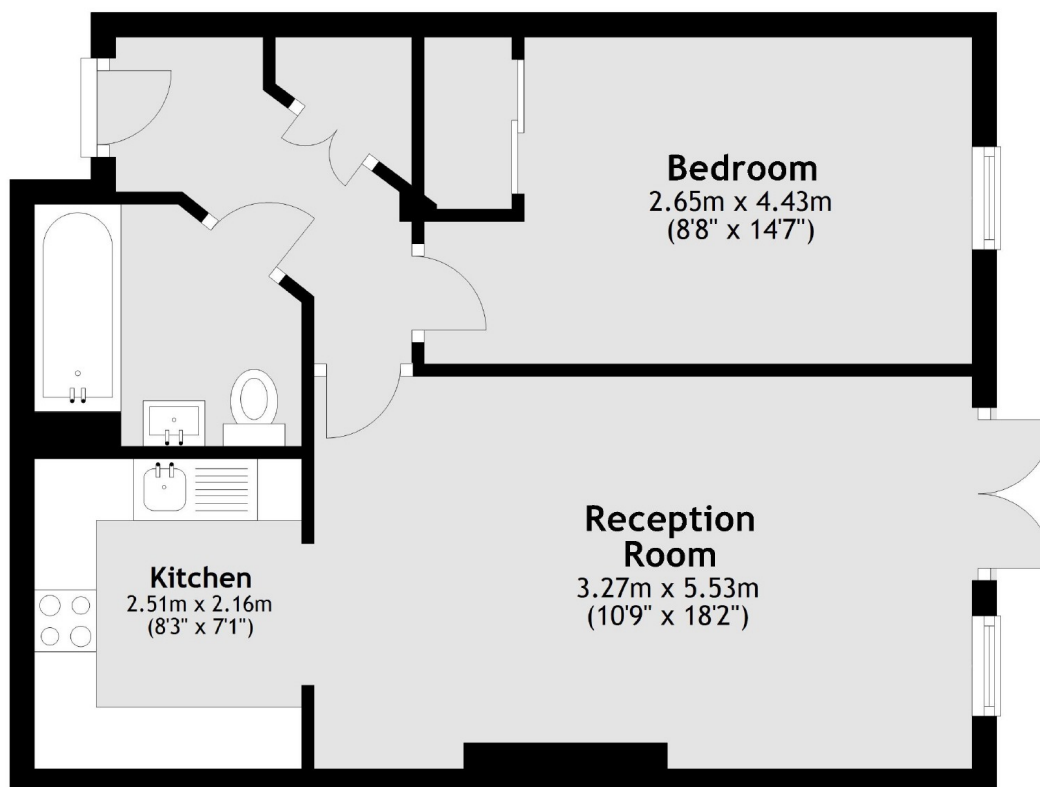

Total area: approx. 44.1 sq. metres (474.2 sq. feet)