



Fassett Road, KT1

£450,000

Situated on the ground floor and to the rear of this stunning period building, that was converted just a few years ago, is this amazing, one off, garden apartment built and finished to an exacting standard. Internally, this one double bedroom apartment is immaculate throughout but the private rear garden is a beautiful space rarely seen with similar apartments.

Fassett Road is a quiet residential road equidistant and just half a mile to Kingston town centre, Surbiton Station and the River Thames, therefore offering the very best of both Kingston and Surbiton and the vast array of shops, bars and restaurants.

Features

- Stunning Apartment
- One Double Bedroom
- Fabulous Private Garden
- Popular Location
- Bi-Folding Doors
- Long Lease



Fassett Road, KT1

Internally, the current owners have created a stunning, contemporary living space having improved on the already exceptional finish. The double bedroom to the front of the apartment has built in wardrobes, a feature panelled wall, plantation shutters and an attractive radiator cover.

The bathroom is beautifully finished with a large walk in shower, built in cabinets and stylish tiled walls. The living room is open plan to the fabulous fitted kitchen with an attractive breakfast bar separating the two areas. The sitting room has large bi-folding doors leading directly onto the private rear garden.

Outside to the front, the apartment is accessed via it's own front door to the side of the building. To the rear is the incredible private garden with a large artificial lawn, large decked area with a pergola and a lovely patio with contemporary patterned tiles. The large brick wall to the rear of the garden will be a spectacular colourful space in the summer when the climbing flowers are in full bloom.



Fassett Road, Kingston Upon Thames, KT1

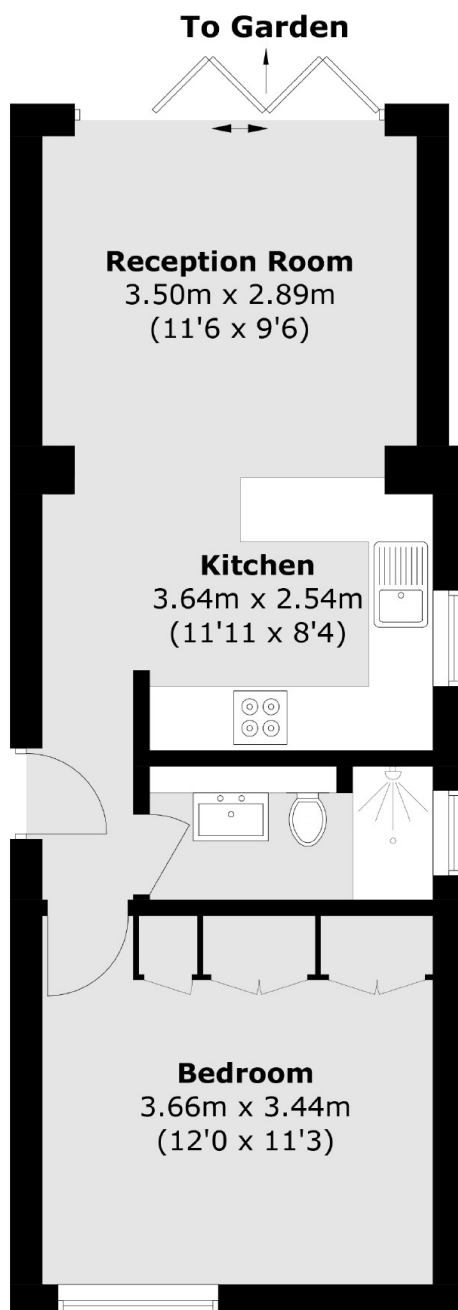

Total area (approx.): 39.3 sq. m (423 sq. ft)