



Shepherd Close, TW13

£450,000

This two double bedroom house offers a great opportunity for first time buyers which is ready to move into with the added benefits of being in a quiet cul-de-sac and having off street parking.

Shepherd Close is ideally located for all local amenities and transport links allowing easy access to Chiswick, Ealing, Heathrow, Hounslow, Isleworth and the A4/M3.

Features

- Two Double Bedrooms
- Allocated Parking
- Quiet Cul-De-Sac
- Downstairs WC
- Good condition
- Private Garden

Shepherd Close, Feltham, TW13

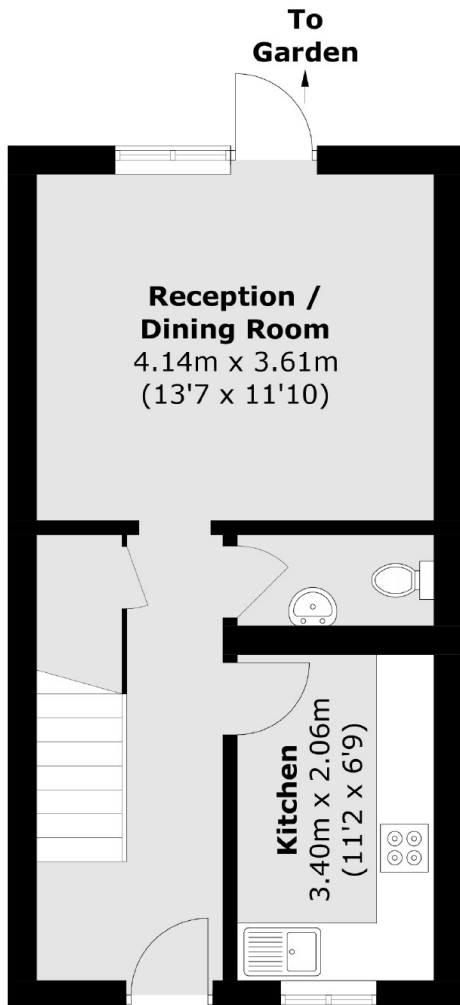

Ground Floor

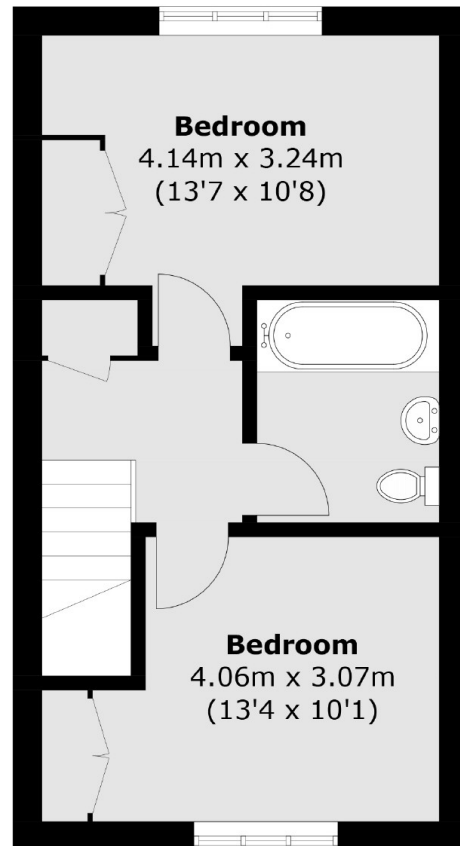

First Floor

Total area (approx.): 69.0 sq. m (742.7 sq. ft)