



## Hampton Road, TW12

### £450,000

We are big fans of this newly built, two bedroom bungalow. Coming with a patio garden and the benefit of no onward chain we are anticipating tons of interest.

Hampton Road is just off Hampton Hill High Street, where everything you need is on your doorstep - local shops, restaurants and cafés, bus routes, Fulwell station and Bushy Park.

### Features

- Bungalow
- Two Bedrooms
- Newly Built
- Patio Garden
- Centrally Located
- No Onward Chain

# Hampton Road, Hampton, TW12

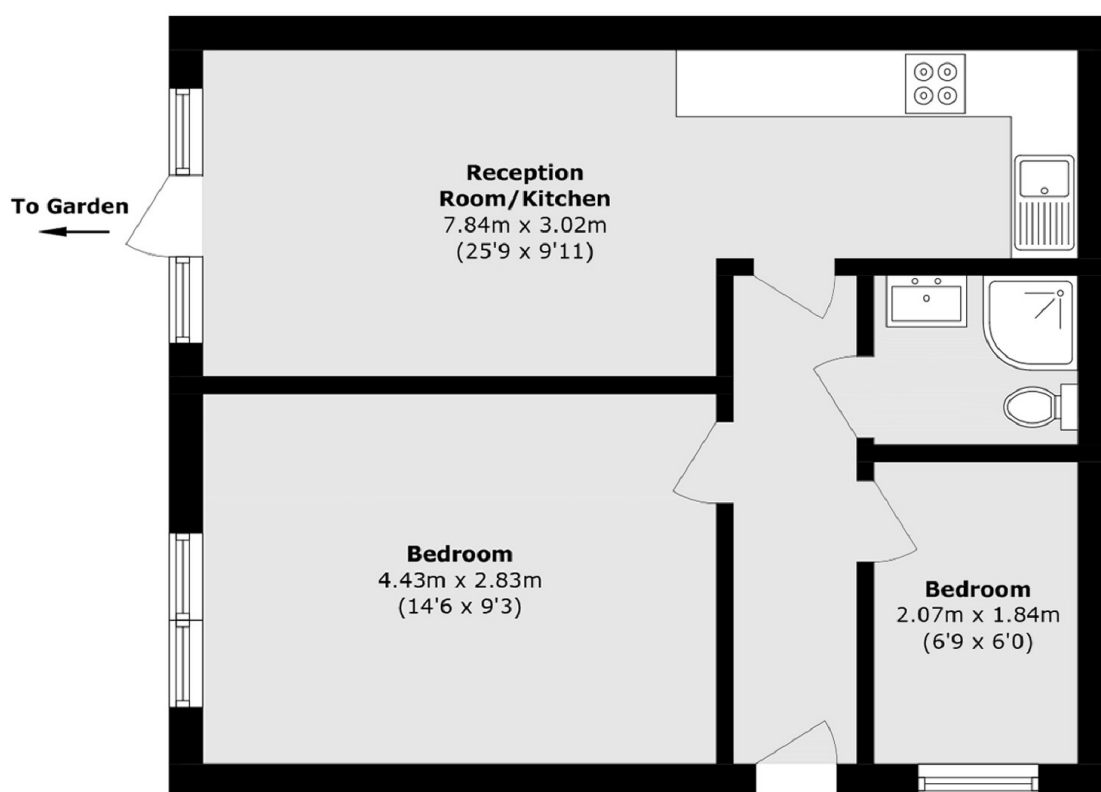

Total area (approx.): 50.1 sq. m (539.2 sq. ft)