



Redford Close, TW13

£200,000

This is a nicely presented, top floor flat which would make a wonderful first time purchase or buy-to-let investment.

Redford Close is a peaceful development, located within easy reach of Feltham High Street full of amenities, shops and restaurants. There are great transport links with a fast train from Feltham station into London and with road links to London, Heathrow and the M3.

Features

- One Double Bedroom
- Good Condition
- Parking Space
- No Onward Chain
- Modern Kitchen
- Close To High Street

Redford Close, Feltham, TW13

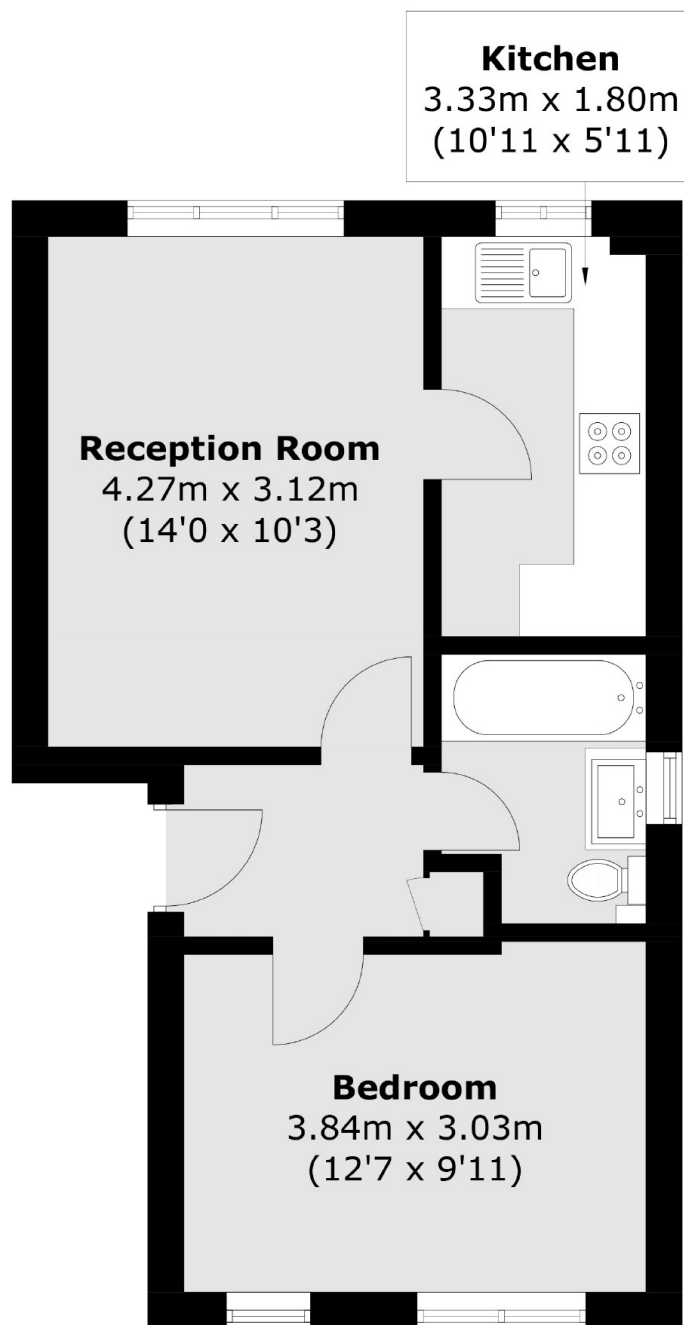

Total area (approx.): 38.7 sq. m (416.6 sq. ft)