



Victoria Avenue, KT8
£440,000

Waterview

A bright and spacious 2nd floor, three bedroom apartment, with it's own private balcony and views of the river from each room, in this lift serviced block with beautiful communal gardens.

Victoria Avenue is located between Hurst Road and Hurst Park adjacent to The Thames and Towpath.





Accommodation is made up of a large double reception room, with dining area and doors to balcony. There is a modern integrated kitchen and larder. There are two double bedrooms, with a further single bedroom all with built-in wardrobes and a family bathroom. The beautifully kept communal gardens have use of a kitchenette and storage space for chairs & tables as well as a barbeque and terrace. There is also a large privately owned garage included in the sale. Off the smart entrance foyer there is a large private store room.

This development is located in the desirable town of Molesey, which is home to an array of lovely cafés and restaurants, as well as being on the door step of the idyllic Hampton Court.

Features

- Large Apartment
- Three Bedrooms
- Private Balcony
- Garage
- Communal Gardens
- No Chain



Victoria Avenue, West Molesey, KT8

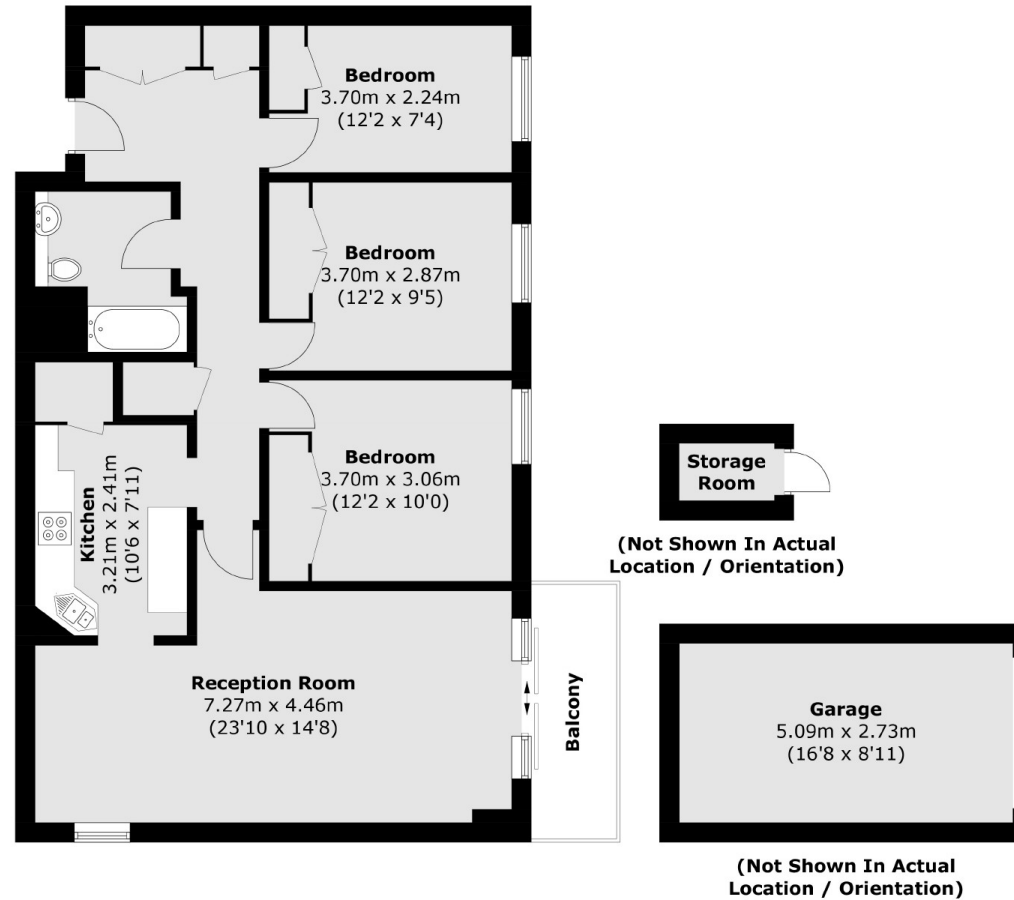

Total area (approx.): 86.7 sq. m (933.2 sq. ft)
Outbuildings: 15.3 sq. m (164.7 sq. ft)

Contact

To arrange a viewing call our office on the number below or visit our website.



Energy Rating: C. We aim to make our particulars both accurate and reliable. However they are not guaranteed; nor do they form part of an offer or contract. If you require clarification on any points then please contact us, especially if you're traveling some distance to view. Please note that appliances and heating systems have not been tested and therefore no warranties can be given as to their good working order.

