



Canterbury Road, TW13

£650,000

An impressive semi-detached family home offering nearly 2,000 sq ft of living space set over three floors. The house offers four double bedrooms, three bathrooms, study and immaculate garden with a swimming pool.

Canterbury Road is a quiet residential road with fantastic transport links nearby. A number of shops, excellent local schools and Crane Park are also located within walking distance.

Features

- Semi Detached
- Four Bedrooms
- Secluded Garden
- Swimming Pool
- Excellent Condition
- Off Street Parking

Canterbury Road, Feltham, TW13

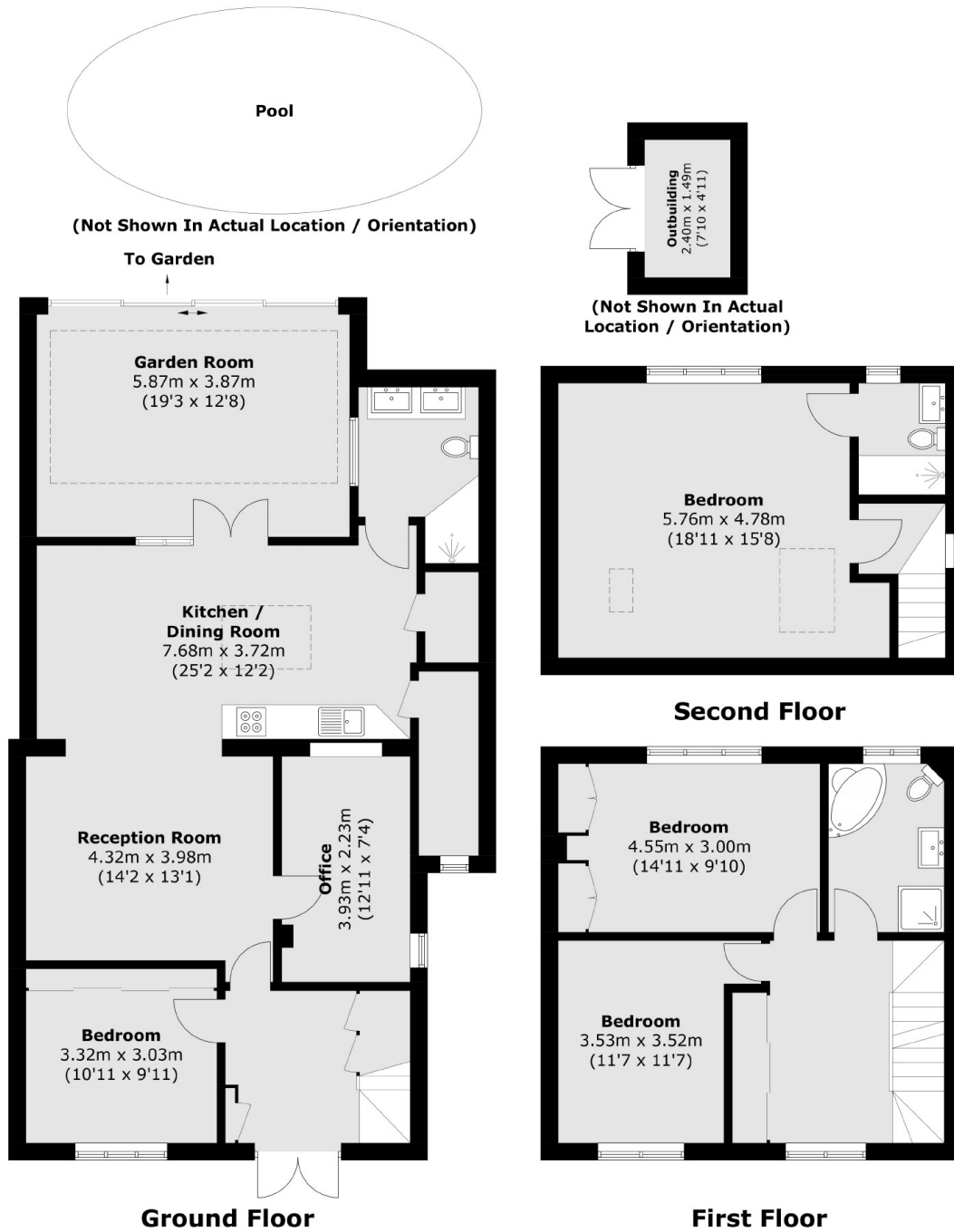

Total area (Approx.): 180.7 sq. m (1,945.0 sq. ft)
Outbuilding : 3.6 sq. m (38.7 sq. ft)