



Kingswood, SL5

£4,500 Per calendar month

Dexters



Kingswood, SL5

The Crown apartments at Kingswood, developed by award-winning Millgate Homes, offer luxurious living within 22 acres of mature woodland. The building features a bright and spacious vaulted entrance hall with lift access to the upper floors.

Located on the first floor, it includes a fully integrated kitchen/breakfast room, a separate utility room, a guest bedroom, and a principal bedroom suite with a walk-in dressing area, en suite, and private balcony.

Residents enjoy a landscaped central green, two parking spaces, a secure storage locker, and street-level visitor parking.

Nearby sporting facilities include racing at Ascot and Windsor, polo at Smith's Lawn, Windsor Great Park, and the Royal County of Berkshire Polo Club at Winkfield, and golf at Wentworth, Sunningdale, Maidenhead, Henley, and Marlow.

Local attractions include Virginia Water Lake, Windsor Castle, Ascot Heath, Thorpe Park, and Legoland. The area is known for its exceptional schools such as Eton College, Wellington, Lambrook, Papplewick, TASIS, and ACS.

Features

- Two Double Bedrooms
- Modern throughout
- Two Bathrooms
- Balcony
- Two Allocated Parking Spaces
- Stunning Development







Kingswood, Ascot, SL5

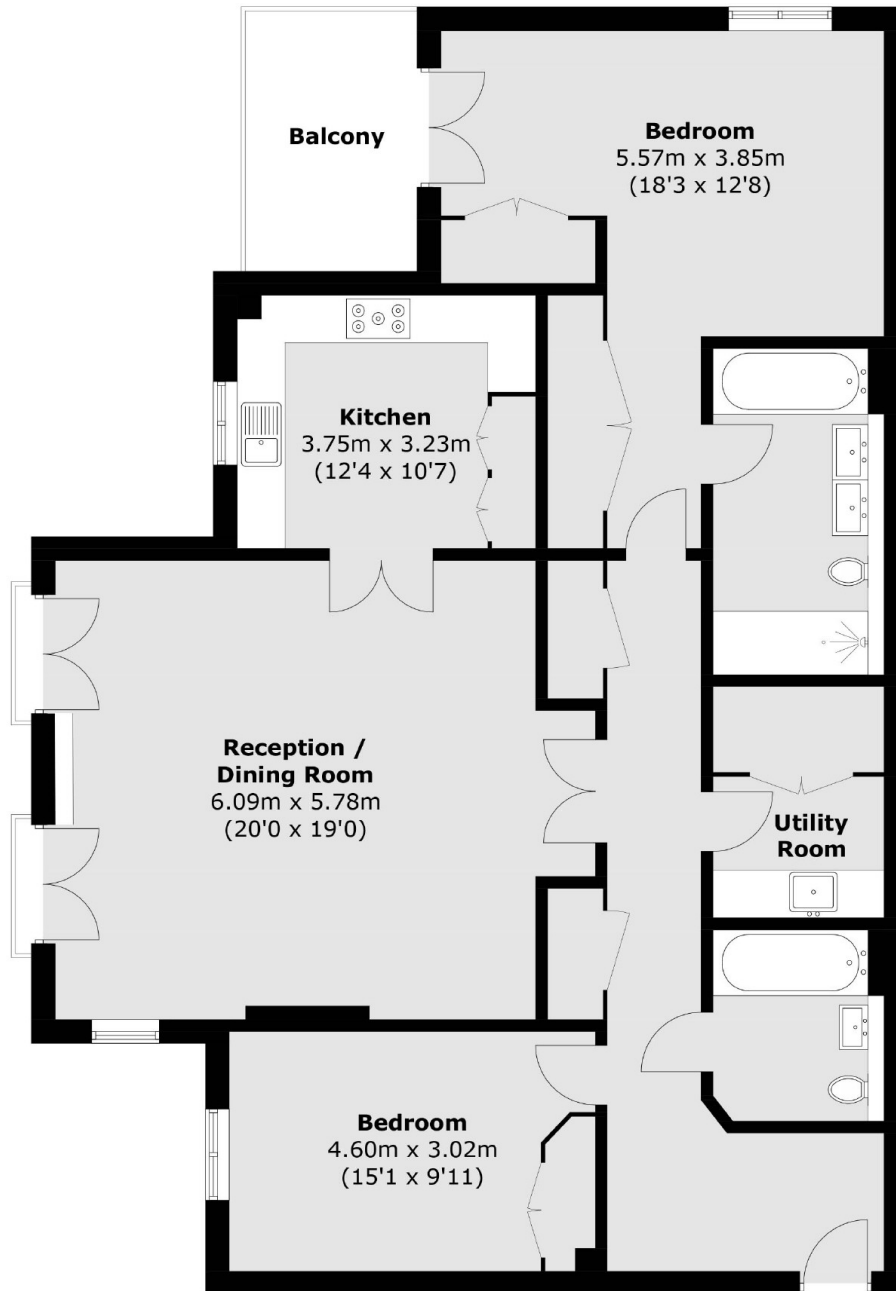

Total area (approx.): 132.8 sq. m (1,429.4 sq. ft)
Balcony: 7.1 sq. m (76.4 sq. ft)