



Sunmead Road, TW16

£2,300 Per calendar month

This is a beautifully presented three double bedroom home, neutrally decorated throughout and has the added benefit of a utility room and integral garage.

Sunmead Road is a sought after, peaceful residential road, close to Sunbury cross, Sunbury village, the river Thames and the walled gardens café.

Features

- Three Bedrooms
- Modern Kitchen
- Secluded Garden
- Integral Garage
- Off-Street Parking
- Large Lounge

Sunmead Road, Sunbury-On-Thames, TW16

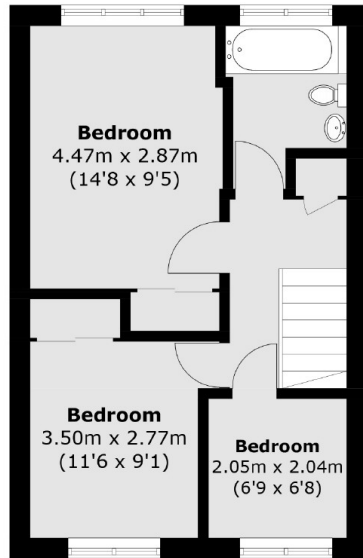

Second Floor

To Garden

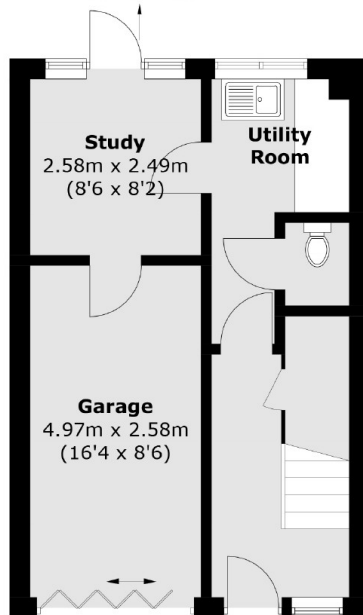

Ground Floor

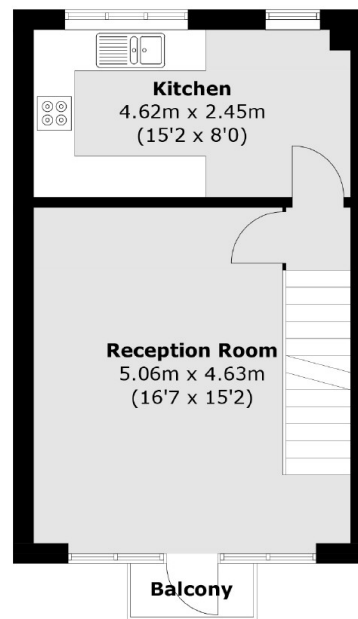

First Floor

Total area (approx.): 106.1 sq. m (1,142.0 sq. ft)
Balcony: 1.4 sq. m (15.1 sq. ft)