



Main Street, TW13

£575,000

This is a four bedroom semi detached house that comes with a newly built garden room, has scope to further extend (subject to planning permission) and off street parking. We would love for you to take a look - when are you free?

Situated on the borders of Hampton and Hanworth, Main Street is minutes from the A316 providing easy access to London and the South Coast via the M3.

Features

- Four Bedrooms
- Three Bathrooms
- Semi Detached
- Garden Room
- Off Street Parking
- Private Garden

Main Street, Feltham, TW13

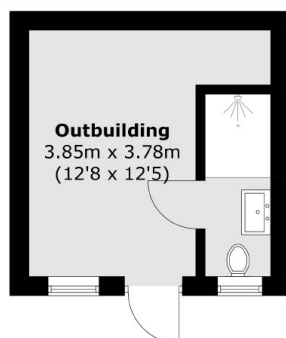

(Not Shown In Actual
Location / Orientation)

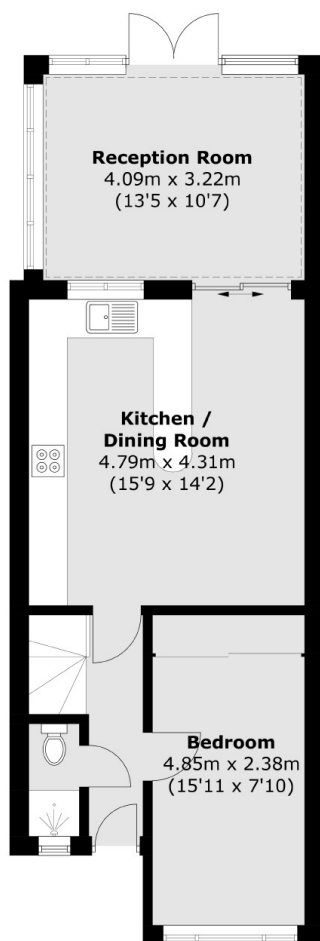

Ground Floor

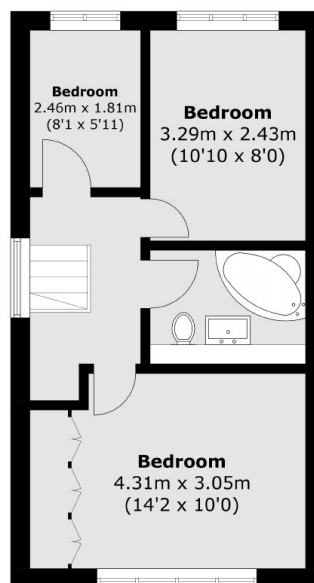

First Floor

Total area (approx.): 90.5 sq. m (974.1 sq. ft)
Outbuilding : 14.7 sq. m (158.2 sq. ft)