



## Devonshire Road, TW13

### £440,000

This is a three bedroom house with a brilliant sized, South West facing garden. It comes with scope for to extend (Subject to Planning Permission) and we are keen to arrange for you to view.

Located in a quiet residential road with easy access to the A316 and Heathrow Airport. The property is conveniently located with bus stops a short walk away, with buses through to Kingston, Hounslow, Heathrow airport, Feltham, Staines and Twickenham.

### Features

- Three Bedrooms
- South West Facing Garden
- Scope To Extend (STPP)
- Mid Terraced
- Quiet Cul-De-Sac
- Close Links To The A316

# Devonshire Road, Feltham, TW13

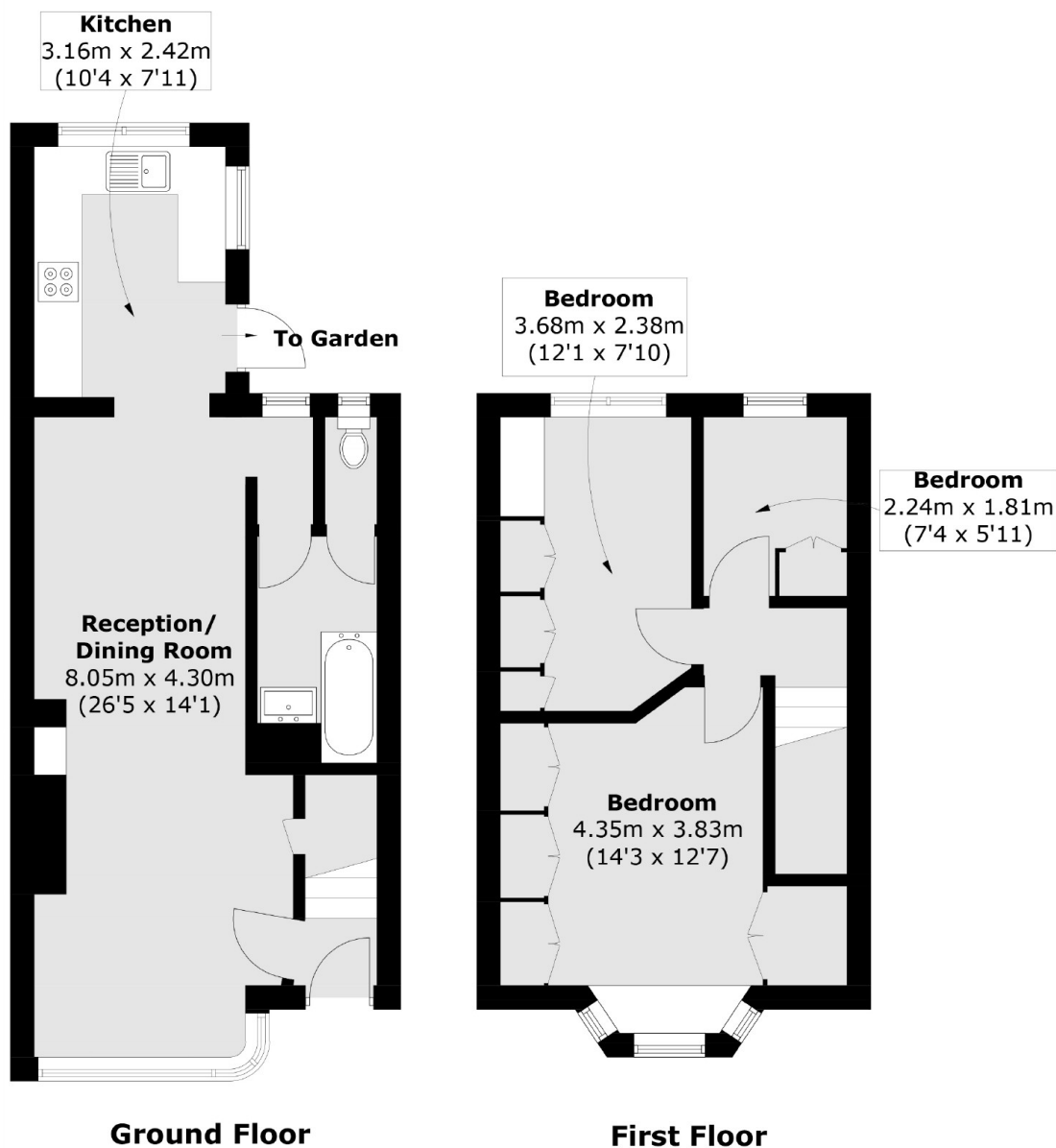

Total area (approx.): 72.6 sq. m (781.5 sq. ft)