



Cranmer Court, TW12

£379,950

We are huge fans of this one bedroom maisonette coming with front and back gardens, a garage, share of freehold and no onward chain. It makes the ideal downsize or first time buy and we are keen to arrange for you to view.

Cranmer Court is set on a very popular residential road located moments from Bushy Park, Hampton Hill High Street, Fulwell Train Station and excellent local schools, both primary and secondary.

Features

- One Bedroom
- Maisonette
- Private Garden
- Share Of Freehold
- Garage
- No Onward Chain

Cranmer Court, Hampton, TW12

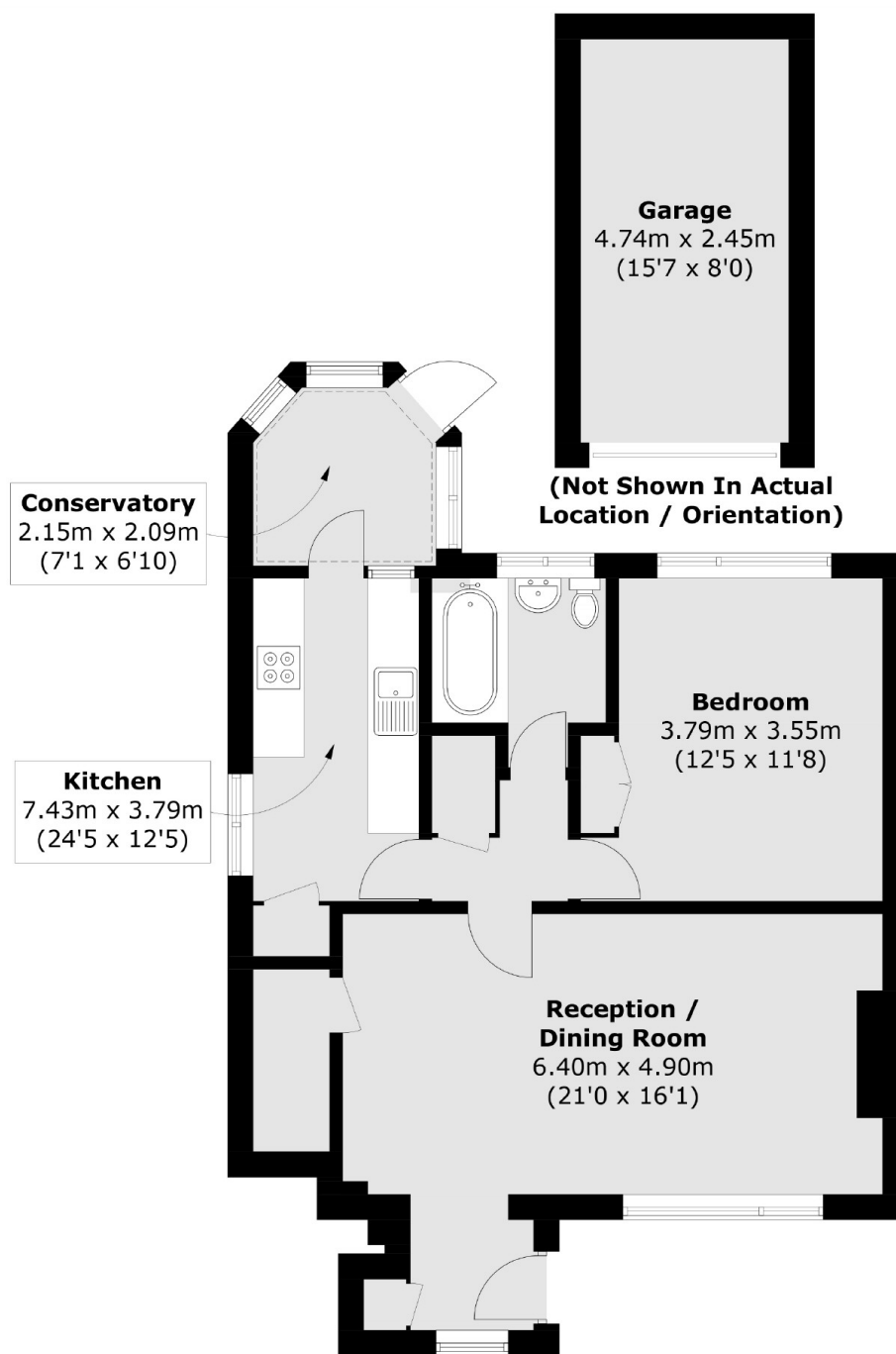

Ground Floor

Total area (approx.): 60.5 sq. m (651.2 sq. ft)
Garage area (approx.): 11.6 sq. m (124.9 sq. ft)