



Station Road, TW12

£1,095,000

This is a great investment opportunity with circa 2400 square feet of flexible accommodation spread over three floors. Coming with a garage and new lease upon completion we are keen for you to view.

Located in the heart of Hampton Village, moments from the shops, restaurants and cafés. The River Thames and Bushy Park are close by, as is Hampton Train Station.

Features

- New Lease Upon Completion
- Three Bathrooms
- Seven Bedrooms
- Three Reception Rooms
- Garage
- Circa 2400 sq. ft

Station Road, Hampton, TW12

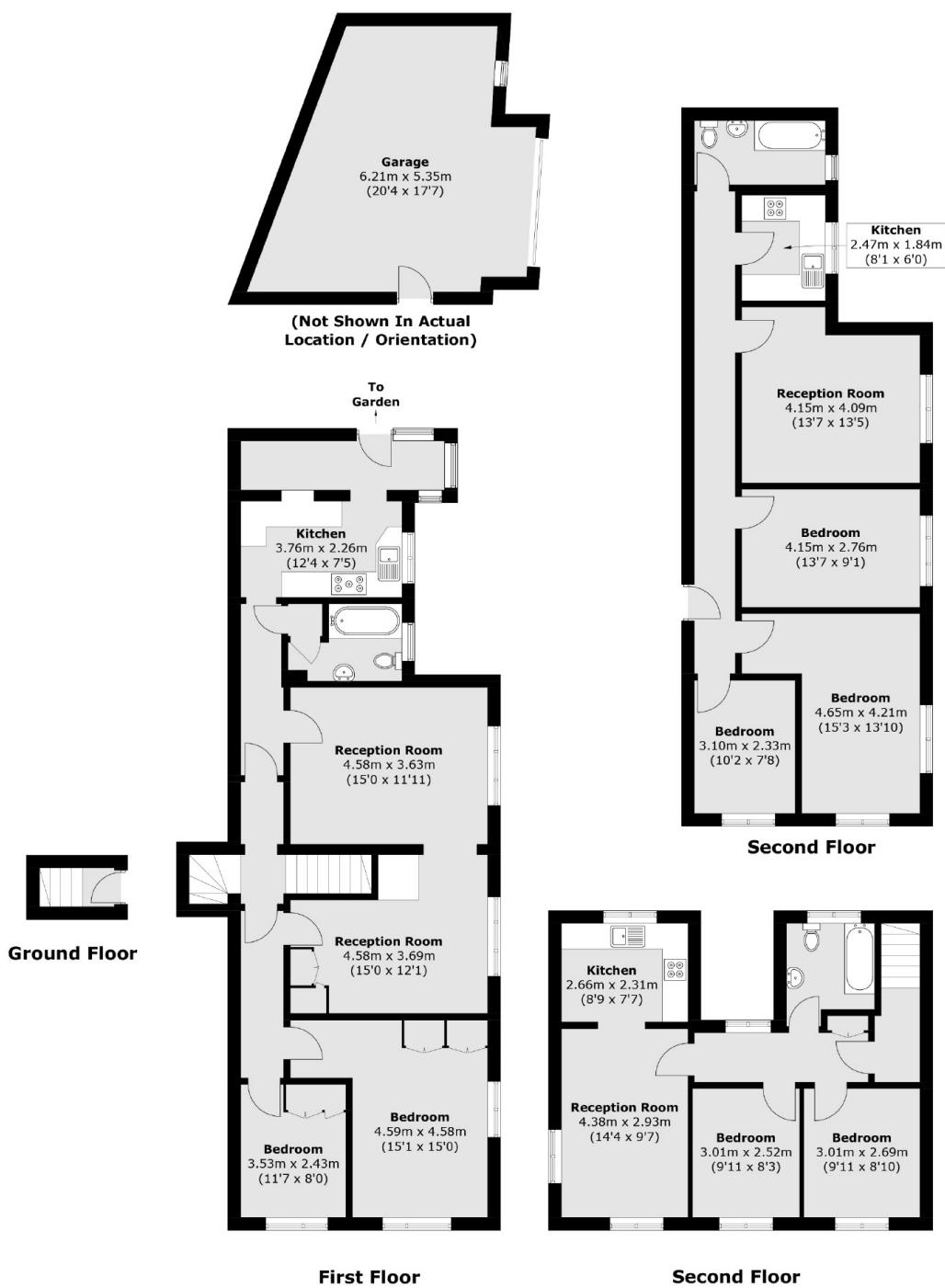

Total area (approx.): 222.1 sq. m (2390.3 sq. ft)
Garage: 31.6 sq. m (340.1 sq. ft)