



## Hartismere Road, SW6

£950,000

A best-in-class three-bedroom, split-level period conversion with its own private entrance. The property boasts an enviable dual-aspect open-plan kitchen and living area, which opens directly onto a private roof terrace. High ceilings throughout and an abundance of natural light further enhance the sense of space and quality.

Located almost equidistant between Fulham Broadway and Parsons Green, the property is enviably situated within SW6. The boutique shops, restaurants and bars on both the New Kings Road and Fulham Road are only a short walk away.

### Features

- Open Plan Kitchen Living
- Split Level Period Conversion
- Private Roof Terrace
- Own Front Door
- Potential to Extend ( SSTP )
- Well Finished Throughout

# Hartismere Road, London, SW6

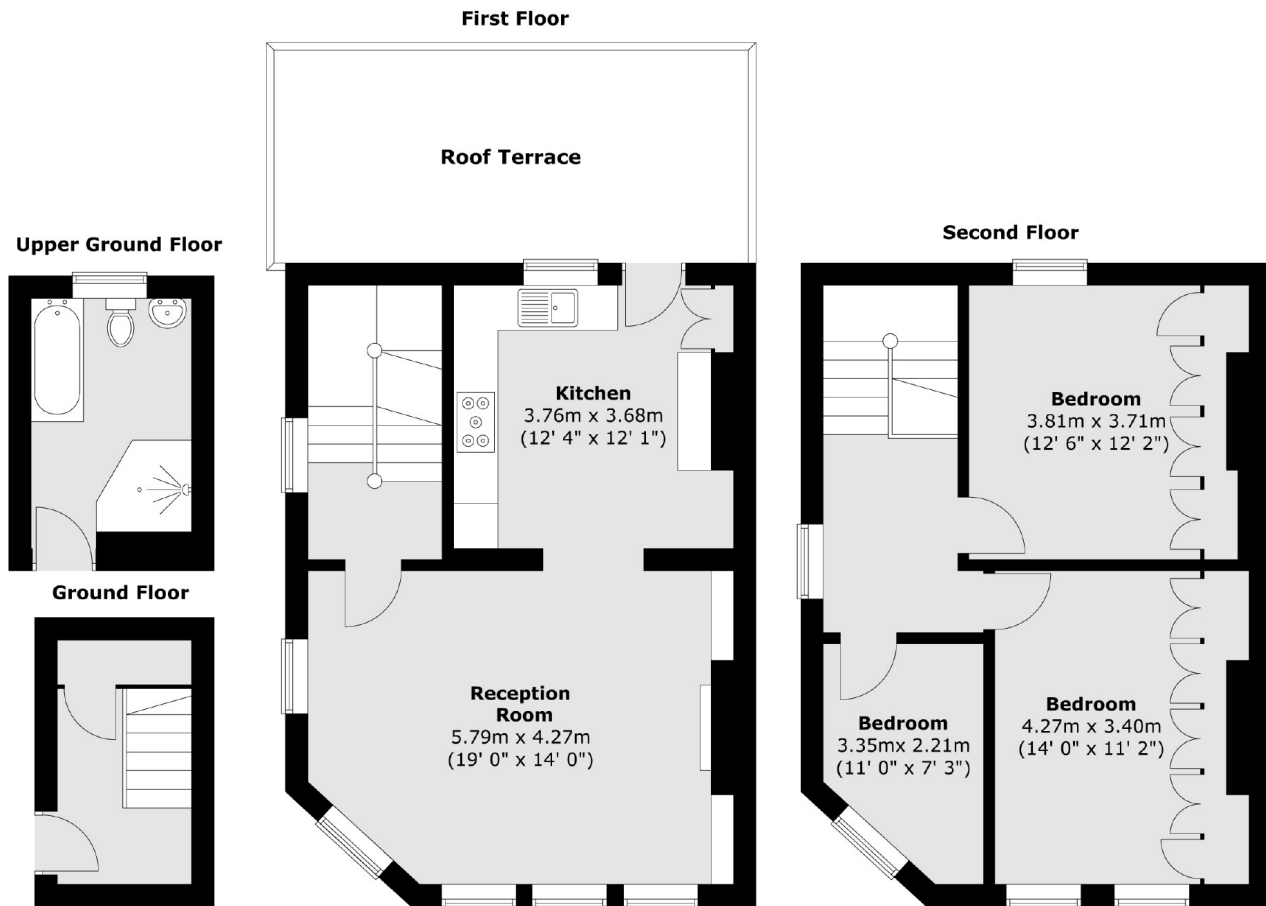

Total area (approx.) : 106 sq. m (1141 sq. ft)  
Total roof terrace area (approx.) : 17.1 sq. m (185 sq. ft)

## Dexters

Fulham  
569 Fulham Road  
London  
SW6 1ES  
Sales  
020 7386 5386

Energy Rating: D. We aim to make our particulars both accurate and reliable. However they are not guaranteed; nor do they form part of an offer or contract. If you require clarification on any points then please contact us, especially if you're traveling some distance to view. Please note that appliances and heating systems have not been tested and therefore no warranties can be given as to their good working order.

 **RICS** | Regulated  
Estate Agent  
and Letting Agent

[dexters.co.uk](https://www.dexters.co.uk)