



## Brompton Park Crescent, SW6

£714 Per week

An immaculately presented two bedroom apartment in this popular gated development. The property offers an open plan kitchen/reception room leading out to the patio garden, wood flooring, two bedrooms and two bathrooms.

Brompton Park Crescent is a gated development close to the amenities of Old Brompton Road and transport links of both West Brompton and Fulham Broadway.

### Features

- Gated Development
- Open Plan
- Two Bathrooms
- Wood Flooring
- Private Patio Garden
- Residential Pool and Gymnasium

# Brompton Park Crescent, Fulham, SW6

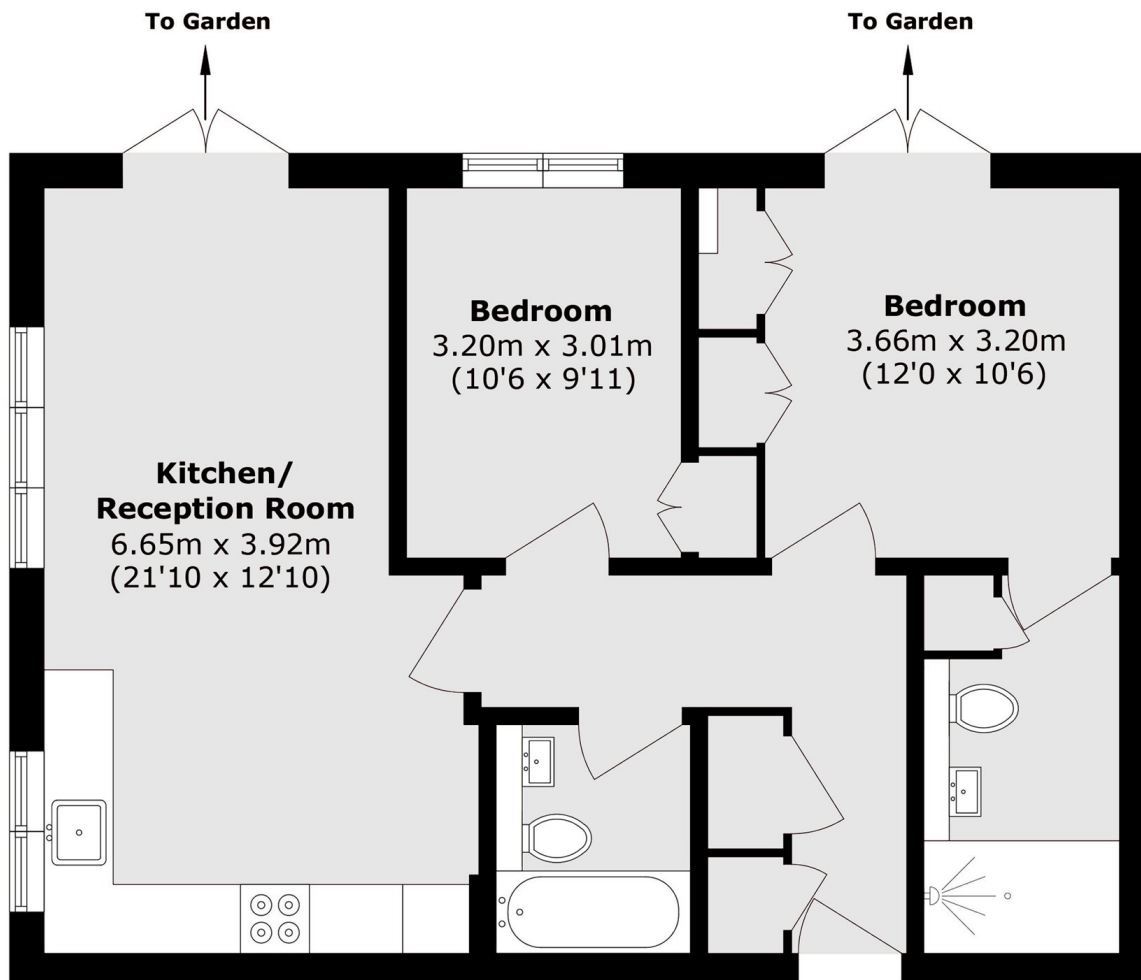

## Ground Floor

Total area (approx.): 62.2 sq. m (669.5 sq. ft)