



Edith Row, SW6

£1,546 Per week

A stunning and contemporary apartment situated off the Kings Road. Boasting modern fixtures and fittings throughout the property offers a large open plan reception room leading onto two balconies, three double bedrooms and three bathrooms.

Edith Row is perfectly located off the popular Kings Road with the transport links of Fulham Broadway close by.

Features

- Modern Development
- Private Balcony
- Parquet Wood Flooring
- Three Bathrooms
- Concierge
- Kings Road

Edith Row, London, SW6

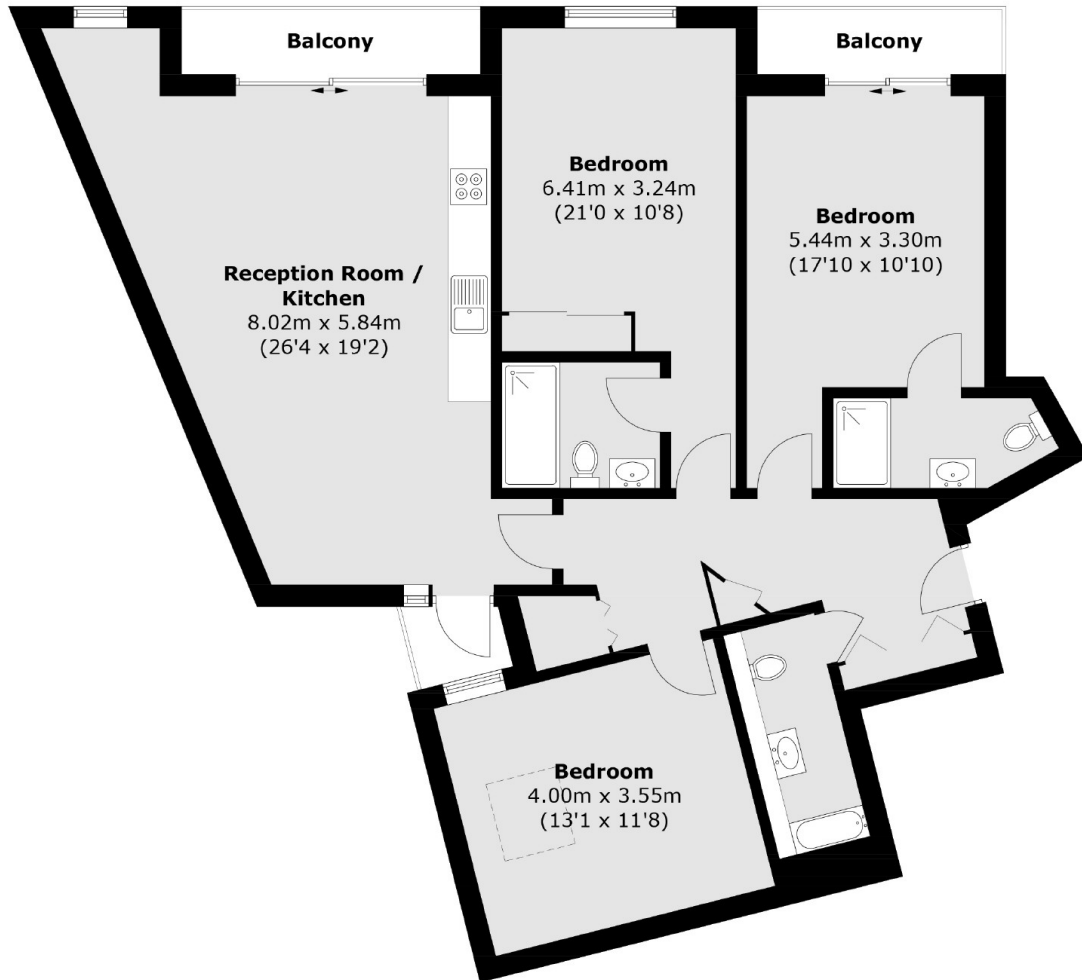

Total area (approx.): 108.0 sq. m (1,162.5 sq. ft)

Dexters

Fulham
569 Fulham Road
London
SW6 1ES
Lettings
020 7386 7386

Energy Rating: B. We aim to make our particulars both accurate and reliable. However they are not guaranteed; nor do they form part of an offer or contract. If you require clarification on any points then please contact us, especially if you're traveling some distance to view. Please note that appliances and heating systems have not been tested and therefore no warranties can be given as to their good working order.

 **RICS** | Regulated
Estate Agent
and Letting Agent

[dexters.co.uk](https://www.dexters.co.uk)