



Moore Park Road, SW6

£575,000

A well finished, first floor two bedroom apartment located on one of Fulham's most sought after streets. The property offers an open plan kitchen living space, two bedrooms and will be sold with no onward chain.

Moments away from Eel Brook Common, the flat is located within close proximity to the amenities and transport links of Fulham Broadway and Parsons Green. The Kings Road is only a short walk away.

Features

- Share Of Freehold
- Two Bedrooms
- First Floor
- Excellent Location
- Open Plan Kitchen Living
- Eel Brook Common

Moore Park Road, London, SW6

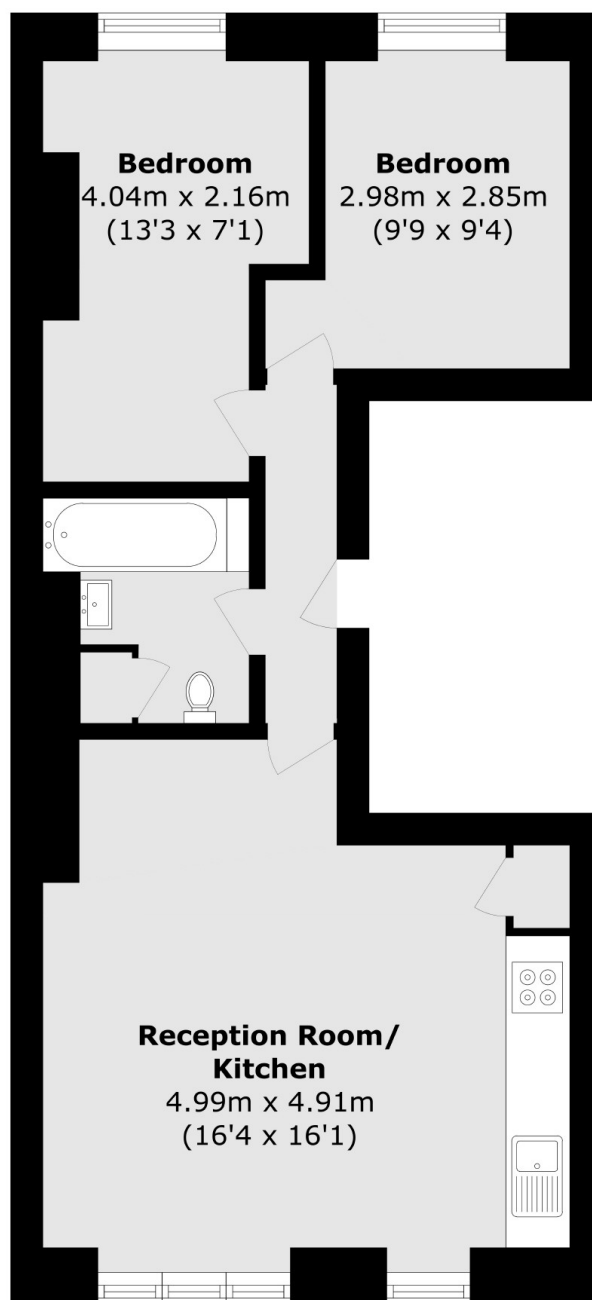

Total area (approx.): 46.6 sq. m (502.6 sq. ft)

Dexters

Fulham
569 Fulham Road
London
SW6 1ES
Sales
020 7386 5386

Energy Rating: E. We aim to make our particulars both accurate and reliable. However they are not guaranteed; nor do they form part of an offer or contract. If you require clarification on any points then please contact us, especially if you're traveling some distance to view. Please note that appliances and heating systems have not been tested and therefore no warranties can be given as to their good working order.

 **RICS** | Regulated
Estate Agent
and Letting Agent

[dexters.co.uk](https://www.dexters.co.uk)