



Brompton Park Crescent, SW6

£500,000

A spacious double bedroom apartment located in this sought after gated complex. The flat boasts a fully integrated kitchen and a spacious living room with direct access to a private balcony.

Brompton Park Crescent is a charming gated community boasting allocated residents parking, beautifully maintained surrounds and a newly refurbished gym along, with a swimming pool and concierge.

Features

- One Double Bedrooms
- Private Balcony
- Gym and Spa Facilities
- Gated Complex
- Private Allocated Parking
- Concierge

Brompton Park Crescent, London, SW6

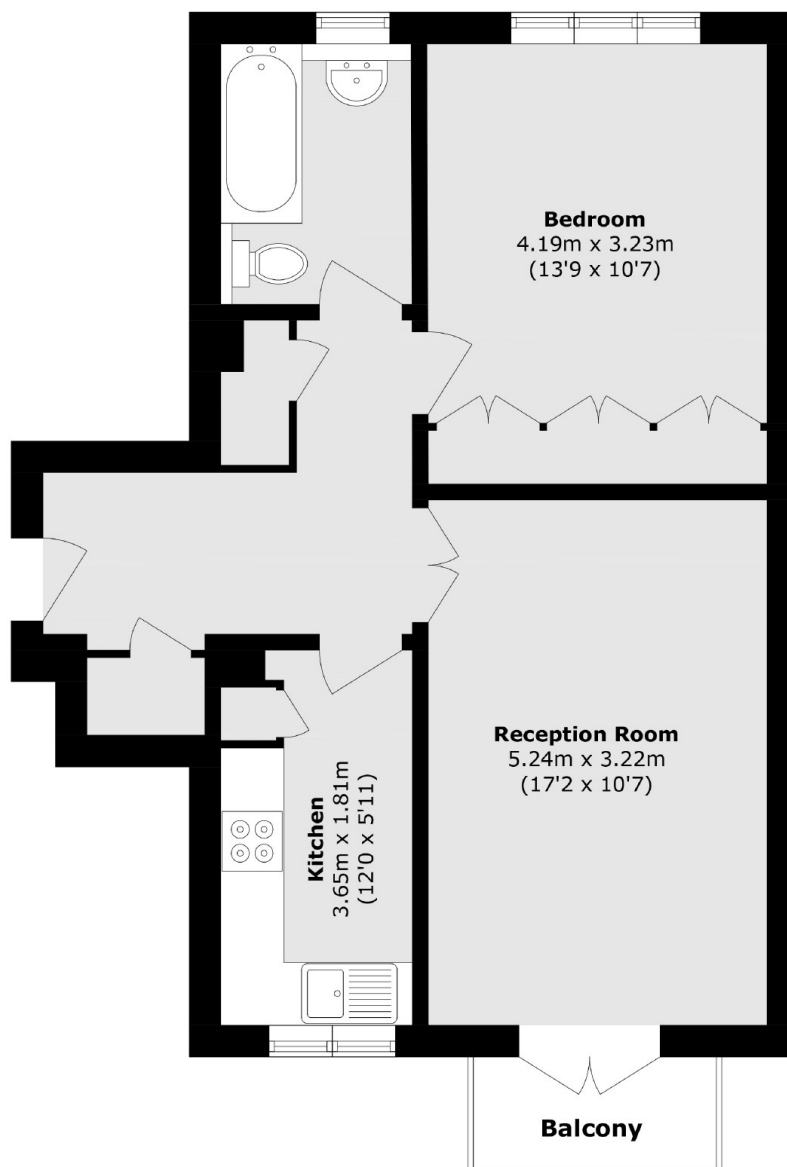

Total area (approx.): 52.3 sq. m (562.9 sq. ft)

Balcony area (approx.): 2.6 sq. m (27.9 sq. ft)

Dexters

Fulham
569 Fulham Road
London
SW6 1ES
Sales
020 7386 5386

Energy Rating: TBC. We aim to make our particulars both accurate and reliable. However they are not guaranteed; nor do they form part of an offer or contract. If you require clarification on any points then please contact us, especially if you're traveling some distance to view. Please note that appliances and heating systems have not been tested and therefore no warranties can be given as to their good working order.

 **RICS** | Regulated
Estate Agent
and Letting Agent

[dexters.co.uk](https://www.dexters.co.uk)