



## Brompton Park Crescent, SW6

£550,000

A beautiful two bedroom flat situated on the second floor of a popular development in the heart of Fulham with lovely views of the tranquil surroundings. The property offers an open plan kitchen living room, two double bedrooms with fitted storage, a fully integrated kitchen, and two balconies overlooking the communal gardens.

Brompton Park Crescent is a charming gated community boasting allocated residents parking, beautifully maintained surrounds and a newly refurbished gym along with a swimming pool and concierge.

### Features

- Two Double Bedrooms
- Two Private Balconies
- Gym and Spa Facilities
- Gated Complex
- Open Plan Kitchen Living
- Private Allocated Parking

# Brompton Park Crescent, London, SW6

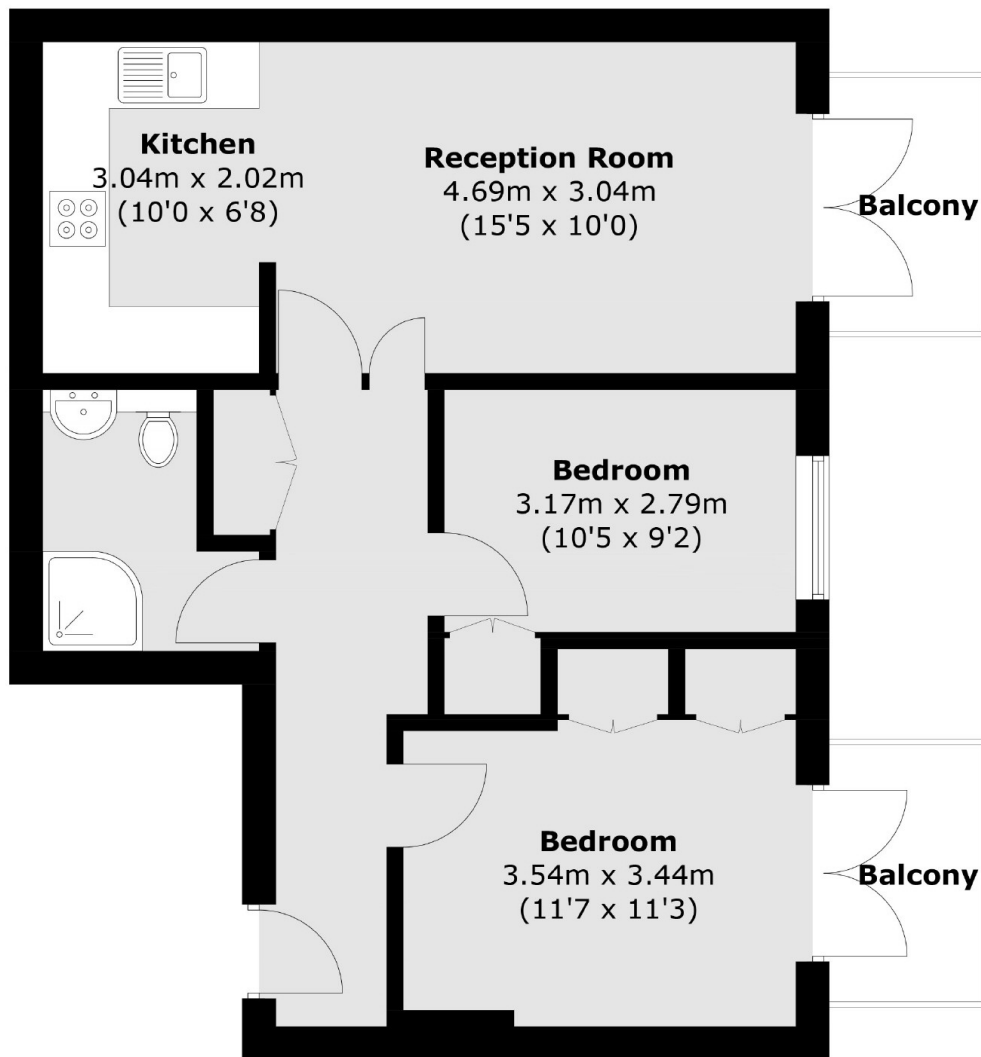

Total area (approx.): 53.2 sq. m (572.9 sq. ft)  
Balcony: 6.4 sq. m (68.9 sq. ft)