



Lillie Road, SW6

£475,000

A very well proportioned double bedroom period conversion flat. The property has a large, open plan kitchen living room with good ceiling height and storage throughout.

Situated within close proximity to the amenities and transport links of Fulham Broadway, West Brompton and Earls Court.

Features

- Good Ceiling Height
- Period Conversion
- Well Finished
- Open Plan
- Ample Storage
- West Brompton

Lillie Road, London, SW6

First Floor

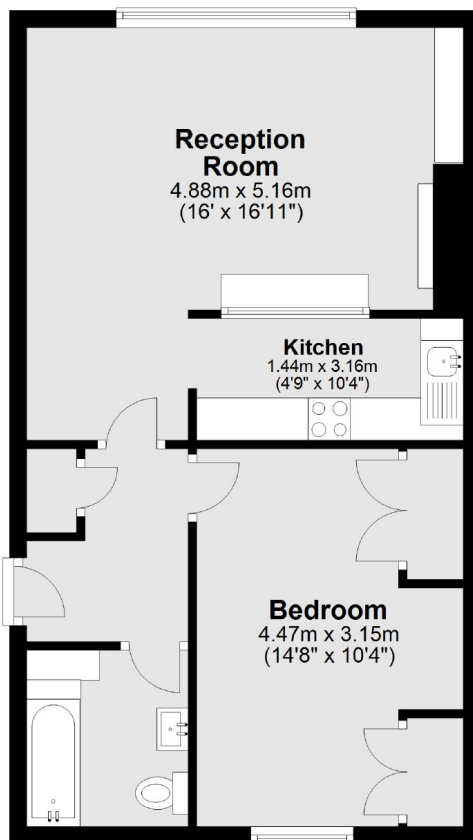

Total area: approx. 48.8 sq. metres (525.0 sq. feet)