



## Glenrosa Street, SW6

£546,000

A two bedroom garden flat situated on the ground floor of this Victorian conversion. The property has potential to be refurbished and extended subject to planning permission.

Glenrosa Street is quiet residential street in the Sands End area of Fulham. The property is well placed for the Chelsea Harbour Club as well as the shops, restaurants, bars and cafés on the Wandsworth Bridge Road.

### Features

- Two Bedrooms
- Ground Floor
- Private Garden
- Potential To Extend (STPP)
- No Chain
- Sands End

# Glenrosa Street, London, SW6

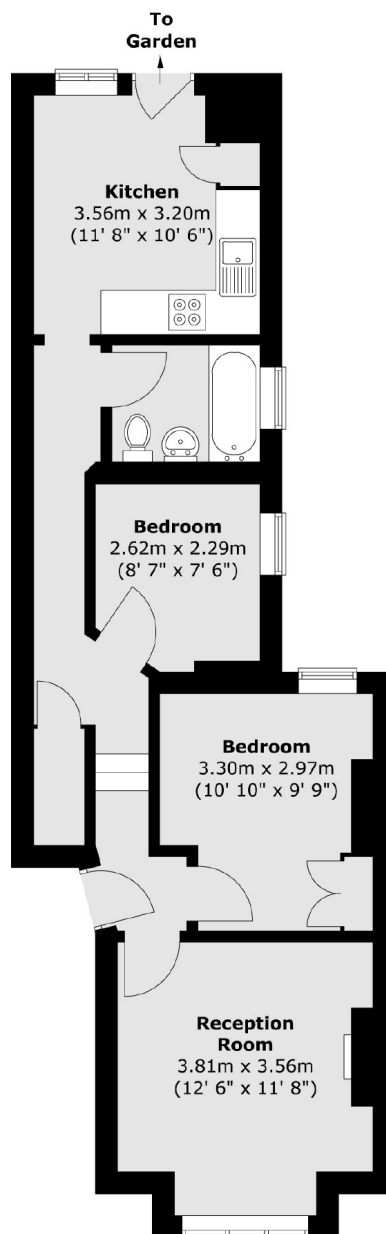

Total area (approx.) : 54.1 sq. m (582 sq. ft)