



Clem Attlee Court, SW6

£550,000

An immaculately finished three double bedroom split level maisonette. The property boasts a fully integrated kitchen, smart heating and a large reception room with direct access to a private balcony that has views of the communal gardens.

Situated on the border of Fulham and West Kensington, the property is within close proximity to amenities and transport links of Fulham Broadway, Earls Court and West Kensington.

Features

- Three Bedrooms
- Immaculately Finished
- Large Living Room
- Separate Kitchen
- Private Balcony
- Split Level

Clem Attlee Court, London, SW6

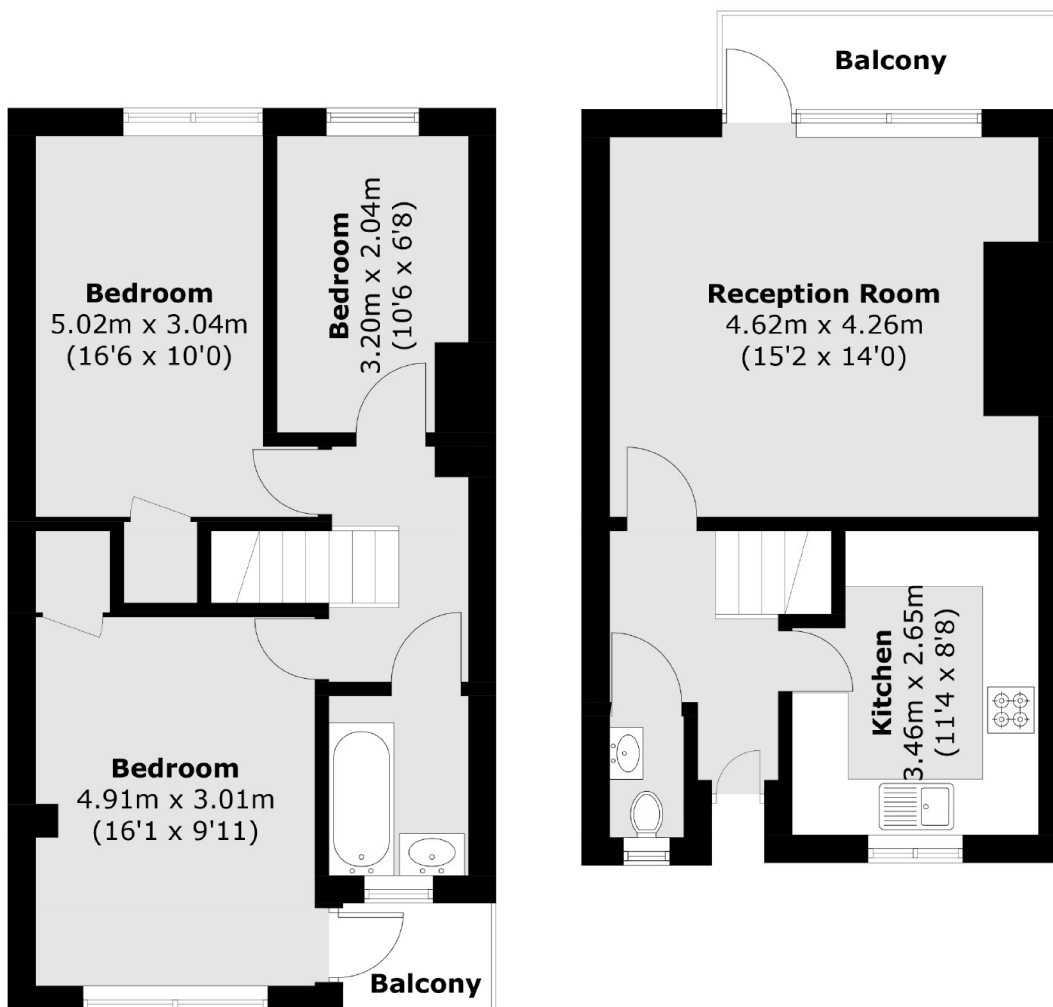

First Floor

Second Floor

Total area (approx.): 75.2 sq. m (809.4 sq. ft)
Balcony : 5.3 sq. m (57.0 sq. ft)