



St. Olaf's Road, SW6

£600,000

A great two double bedroom flat in a sought after mansion block on a quiet residential street located in the heart of Munster village. The property benefits from a separate kitchen, living space and a large private garden of which can be accessed from the living room.

Located on a quiet residential street, the property is within close proximity to the amenities and transport links of the Munster Village, Parsons Green and Fulham Broadway.

Features

- Mansion Block
- Two Double Bedrooms
- Separate Kitchen
- Large Garden
- Munster Village
- Share of Freehold

St. Olaf's Road, London, SW6

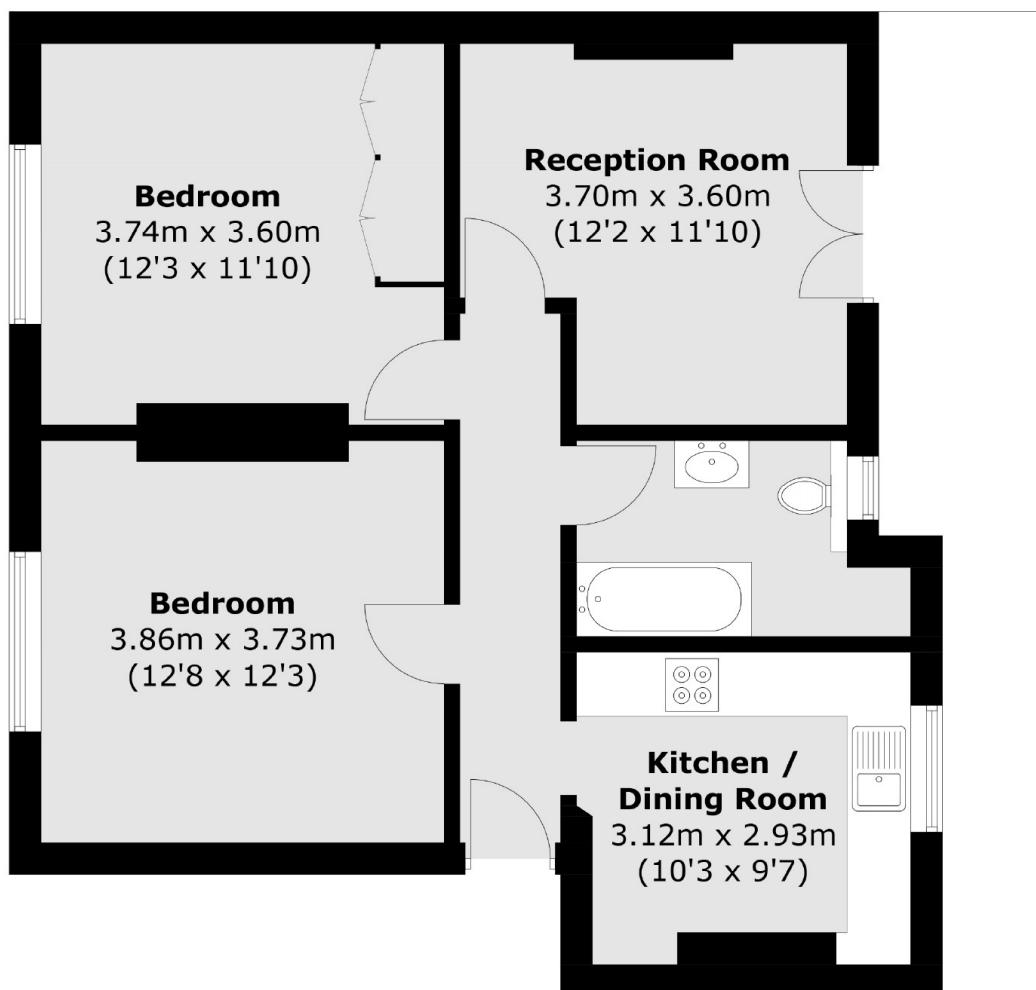

Total area (approx.): 62.7 sq. m (674.9 sq. ft)