

## Dairy Close, SW6

£575,000

A perfectly finished, modern one double bedroom apartment in this purpose built development in the heart of Parsons Green. The property has an open plan kitchen living room, and an enviable wrap around balcony.

Located moments away from the amenities and transport links of Parsons Green.

### Features

- One Double Bedroom
- Wrap Around Balcony
- Open Plan Kitchen Living Room
- Well Finished Throughout
- Sought After Location
- Close To Transport Links

# Dairy Close, London, SW6

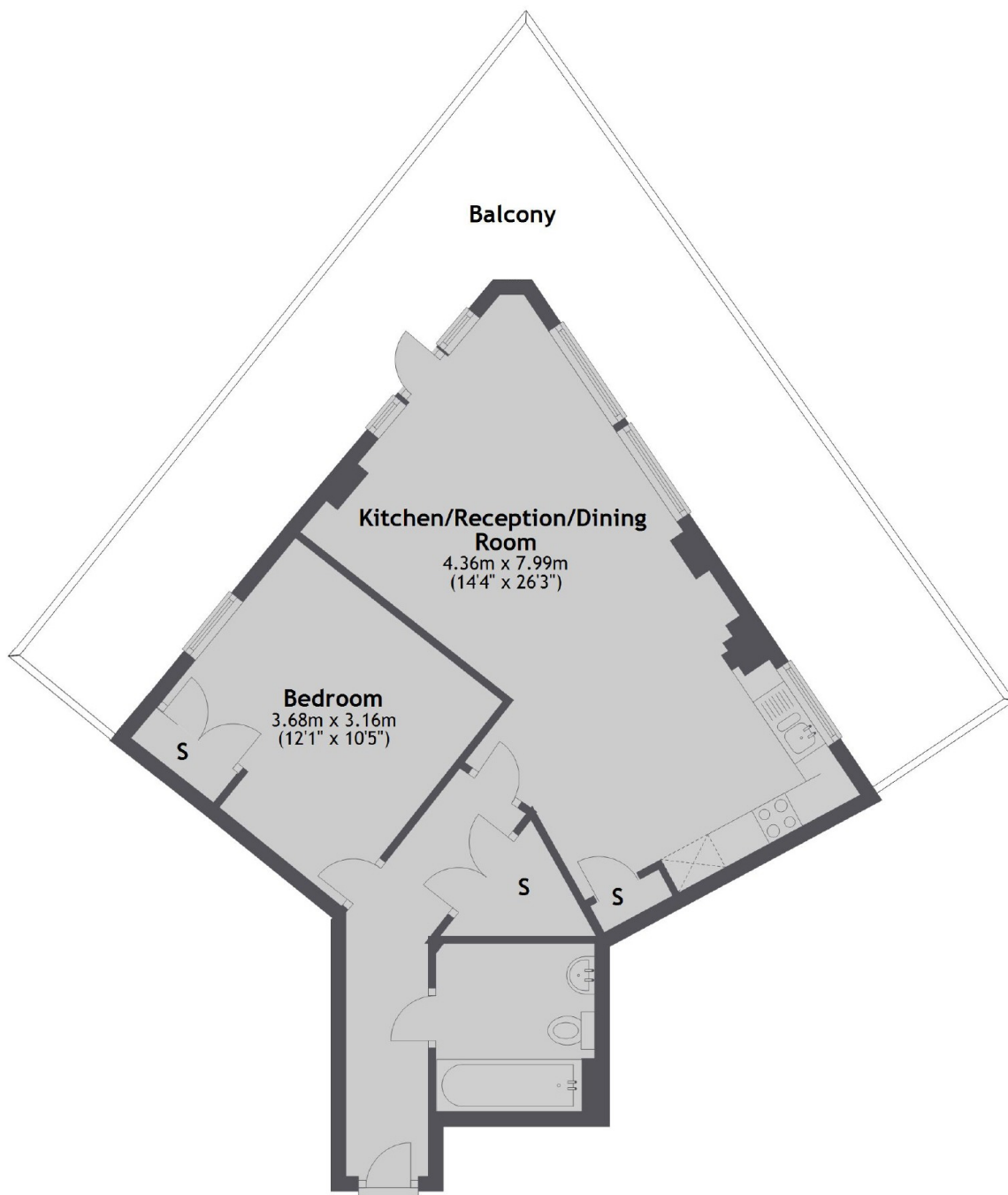

## Second Floor

Total area: approx. 54.9 sq. metres (590.7 sq. feet)