



## Wandsworth Bridge Road, SW6

£550,000

A spacious, two double bedroom split level period conversion close to Parsons Green. The property has an separate kitchen living room, and benefits from having it's own front door.

Located on the more sought after end of the tree lined Wandsworth Bridge Road. The property is close to Eel Brook Common, Parsons Green and Fulham Broadway.

### Features

- Own Front Door
- Two Bedrooms
- Parsons Green
- Split Level Period Conversion
- Close To Transport Links
- Share Of Freehold

# Wandsworth Bridge Road, London, SW6

Ground Floor

First Floor

Second Floor

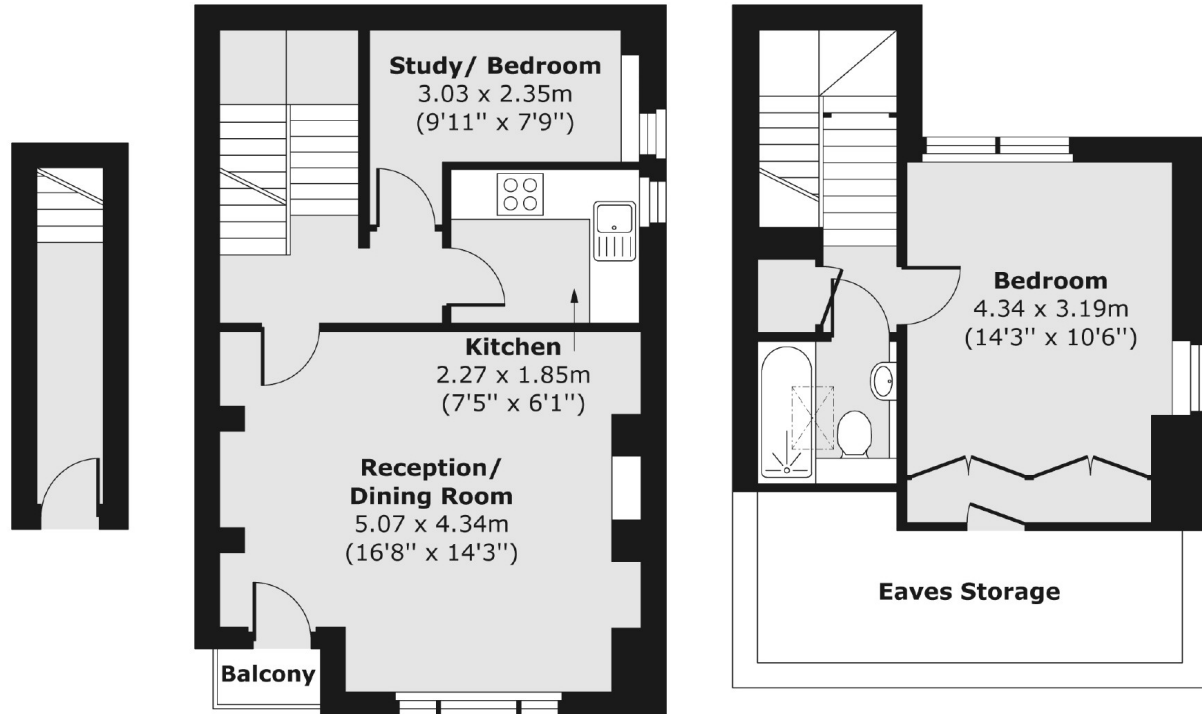

Total area (approx.) 64.75 sq. m (697 sq. ft)

Balcony area (approx.) 0.83 sq. m (9 sq. ft)