



Aspen Close, W5

£900,000

Fully renovated and ground floor extended in immaculate condition throughout, this reconfigured four bedroom end of terrace townhouse is the perfect family home with air conditioning, off street parking and incredible views over the cricket club and playing fields behind.

Conveniently located with the green space of Gunnersbury Park on your doorstep. For the commuter you have easy access to South Ealing, Ealing Broadway and Acton Town stations with the Elizabeth, Central, District and Piccadilly lines.

Features

- Fully Renovated
- Ground Floor Extended
- Four Bedrooms
- Off Street Parking
- Air Conditioning
- Overlooking Playing Fields

Aspen Close, London, W5

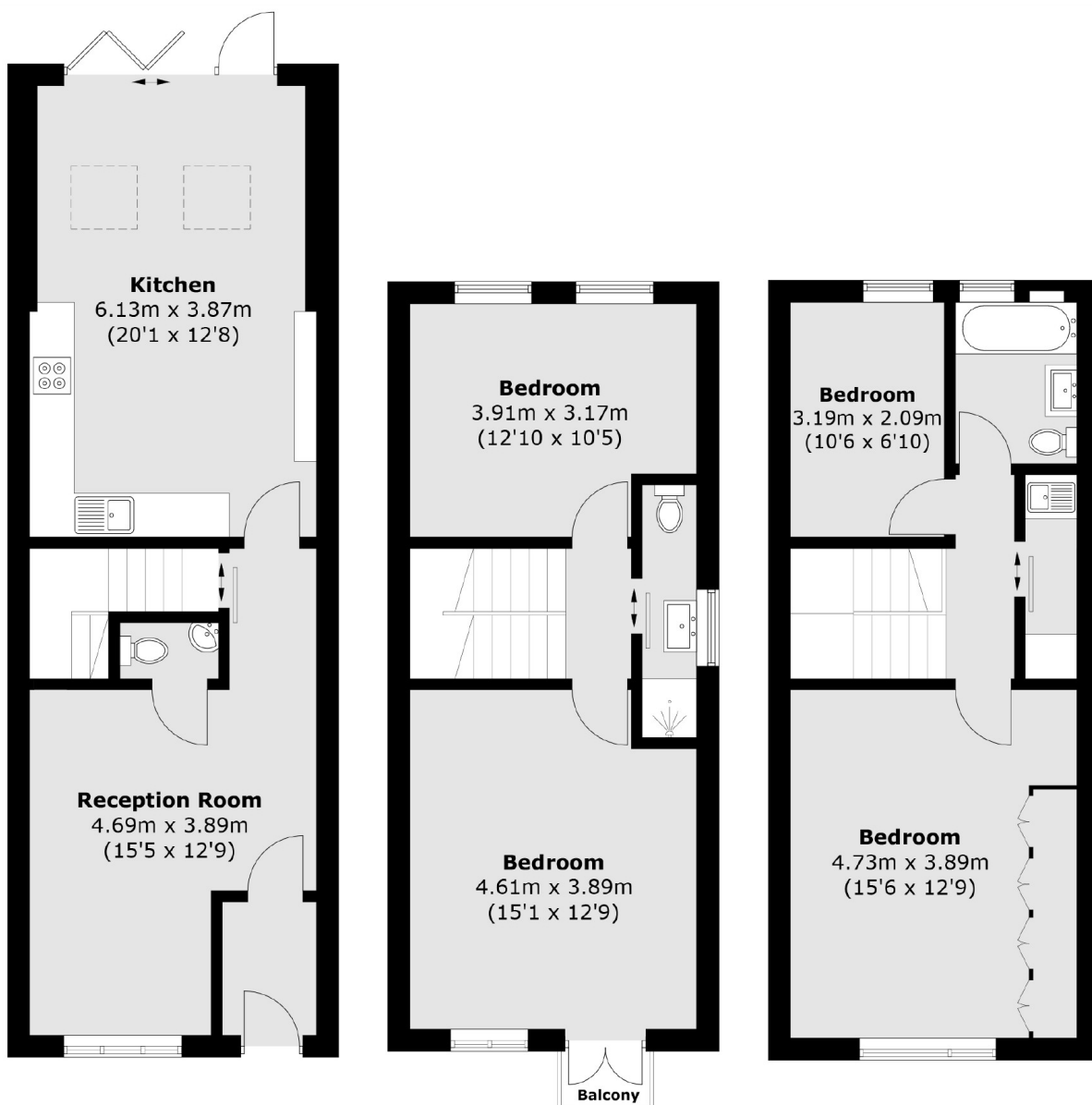

Ground Floor

First Floor

Second Floor

Total area (approx.): 128.1 sq. m (1,378.8 sq. ft)
Balcony area : 0.9 sq. m (9.7 sq. ft)