



Cleveland Road, W13

£1,395,000

A four bedroom semi-detached family home in need of modernisation throughout. Offering significant extension potential into the loft and on the ground floor, the rear garden is substantially larger than average for the area. Potential to be a tremendous forever family home.

Located just half a mile from the West Ealing Elizabeth line station, fourteen minutes to Bond Street, thirteen to Heathrow Airport and approximately thirty to Canary Wharf. There is easy vehicular access to the M4 and A40 and there are numerous excellent local schools, state and private.

Features

- Four Bedrooms
- Large Garden
- Extension Potential
- Modernisation Required
- Garage
- No Onward Chain

Cleveland Road, London, W13

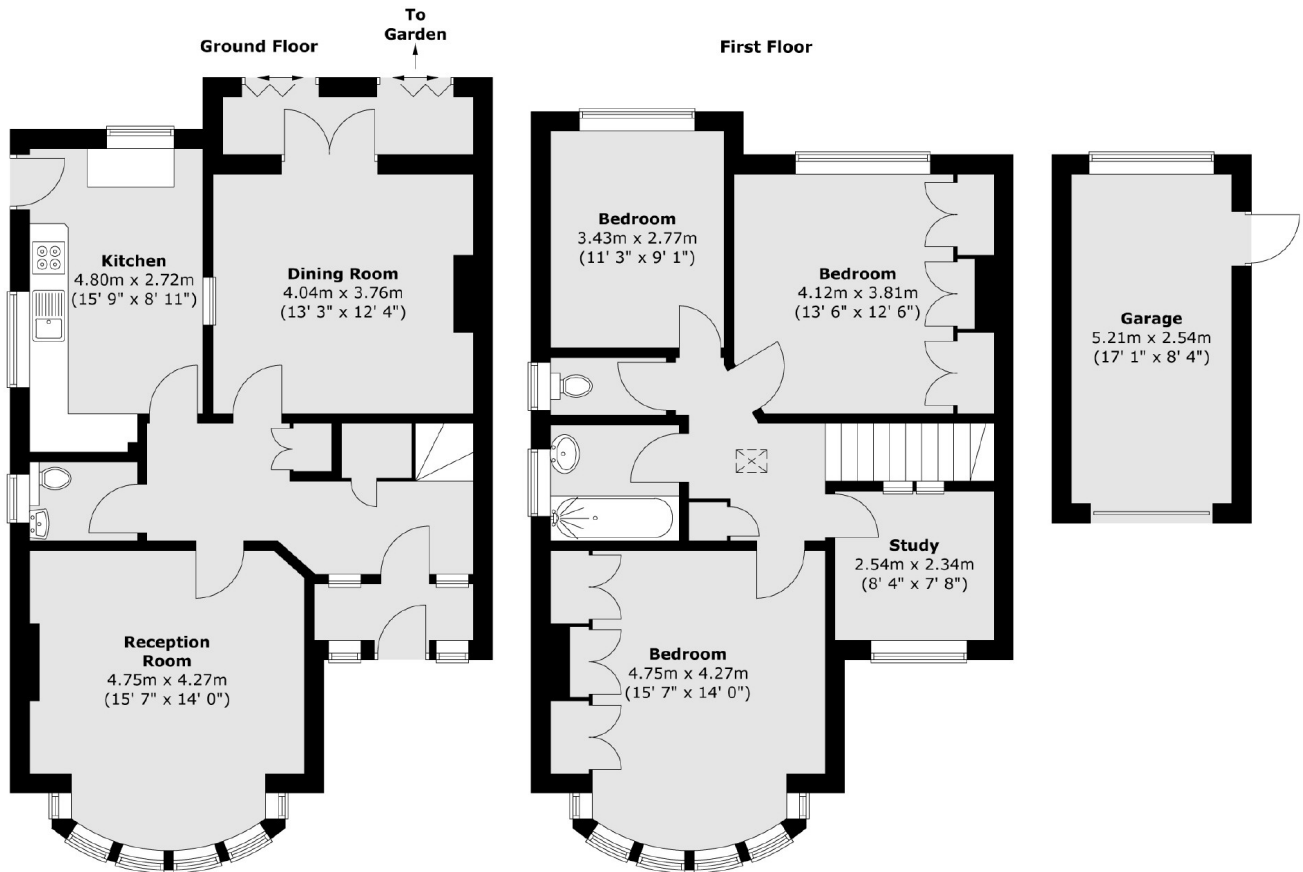

Total area (approx.) : 136.9 sq. m (1473 sq. ft)
Total garage area (approx.) : 13.4 sq. m (144 sq. ft)