



Grange Park, W5

£499,950

This two double bedroom apartment occupies the raised ground floor of a wonderful Victorian building. There are fantastic views from the living room and kitchen over the central green of Grange Park.

Located just moments from Ealing Common and half a mile from the Elizabeth, Central and District lines at Ealing Broadway. There is a wide range of shops, restaurants, gyms and amenities in the centre of Ealing Broadway shopping centre, a short walk away.

Features

- Two Bedrooms
- Raised Ground Floor
- No Onward Chain
- Excellent Condition
- Ealing Common Location
- Close To Transport

Grange Park, London, W5

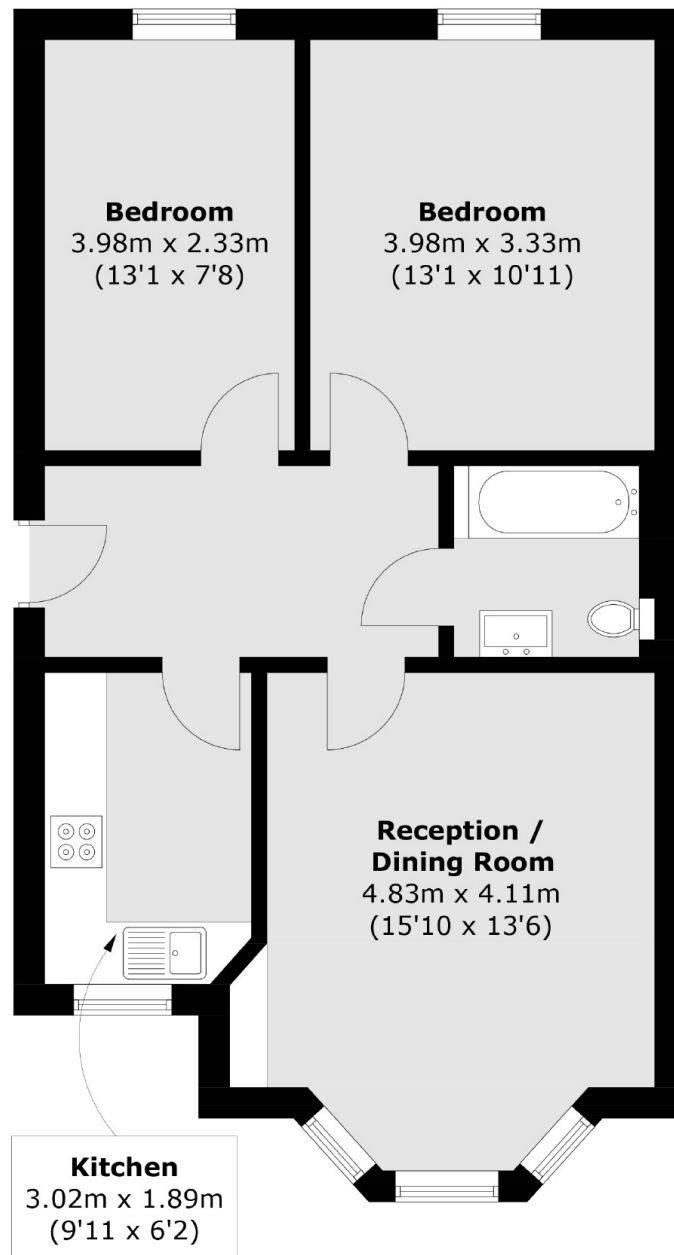

Total area (approx.): 59.8 sq. m (643.7 sq. ft)

Dexters

Ealing
2 New Ealing Broadway
London
W5 2NU
Sales
020 8810 0909

Energy Rating: C. We aim to make our particulars both accurate and reliable. However they are not guaranteed; nor do they form part of an offer or contract. If you require clarification on any points then please contact us, especially if you're traveling some distance to view. Please note that appliances and heating systems have not been tested and therefore no warranties can be given as to their good working order.

 **RICS** | Regulated
Estate Agent
and Letting Agent

[dexters.co.uk](https://www.dexters.co.uk)