



## Corfton Road, W5 £399,999

Located just 0.4 miles from Ealing Broadway, this property on Corfton Road offers a blend of convenience and comfort in one of West London's most desirable areas. With a share of the freehold, you'll enjoy a greater degree of ownership and flexibility compared to standard leasehold properties.

Excellent transport links via Ealing Broadway, including access to the Elizabeth Line, Central Line, and District Line, along with a range of local amenities such as shops, restaurants, and parks. In addition, there are easy routes out of London via the A40.

### Features

- Two Bedrooms
- Close to Ealing Broadway
- Top Floor
- Double Glazed
- Chain Free

Corfton Road,  
London, W5

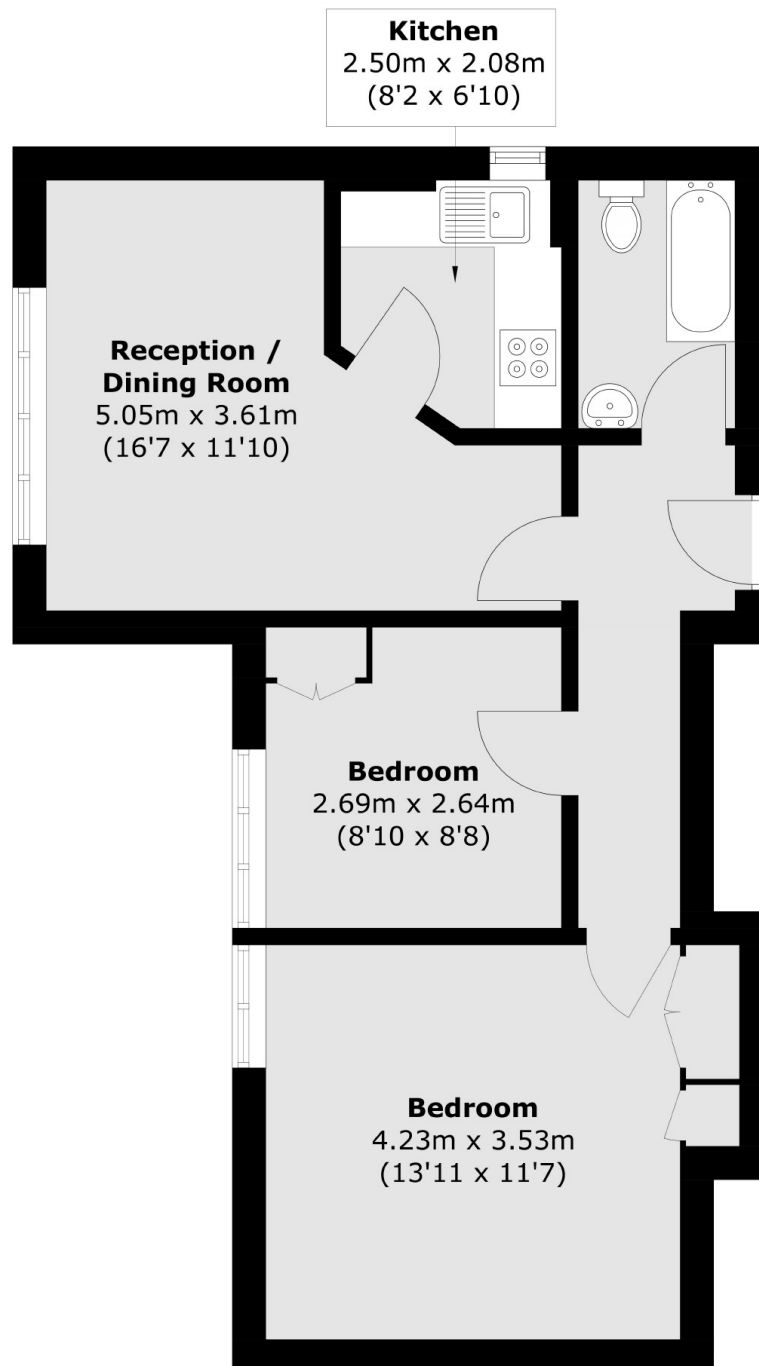

Total area (approx.): 48.9 sq. m (526.3 sq. ft)

**Dexters**

Ealing  
2 New Ealing Broadway  
London  
W5 2NU  
Sales  
020 8810 0909

Energy Rating: D. We aim to make our particulars both accurate and reliable. However they are not guaranteed; nor do they form part of an offer or contract. If you require clarification on any points then please contact us, especially if you're traveling some distance to view. Please note that appliances and heating systems have not been tested and therefore no warranties can be given as to their good working order.

 **RICS** | Regulated  
Estate Agent  
and Letting Agent

[dexters.co.uk](https://www.dexters.co.uk)