



Kent Avenue, W13

£510,000

A split level maisonette with two double bedrooms spanning the first and second floor. On the lower level there is a spacious reception room, separate modern kitchen and balcony. On the upper floor there are two bedrooms and a recently modernised bathroom. There is share of the freehold, garage and views over Cleveland Park.

Located close to Pitshanger and Cleveland Parks with excellent local school, private and state. The award winning Pitshanger Lane high street is a short walk and for the commuter there is easy access to West Ealing and Ealing Broadway Elizabeth line stations.

Features

- Maisonette
- Two Bedrooms
- Split Level
- Balcony
- Garage
- Share Of Freehold

Kent Avenue, London, W13

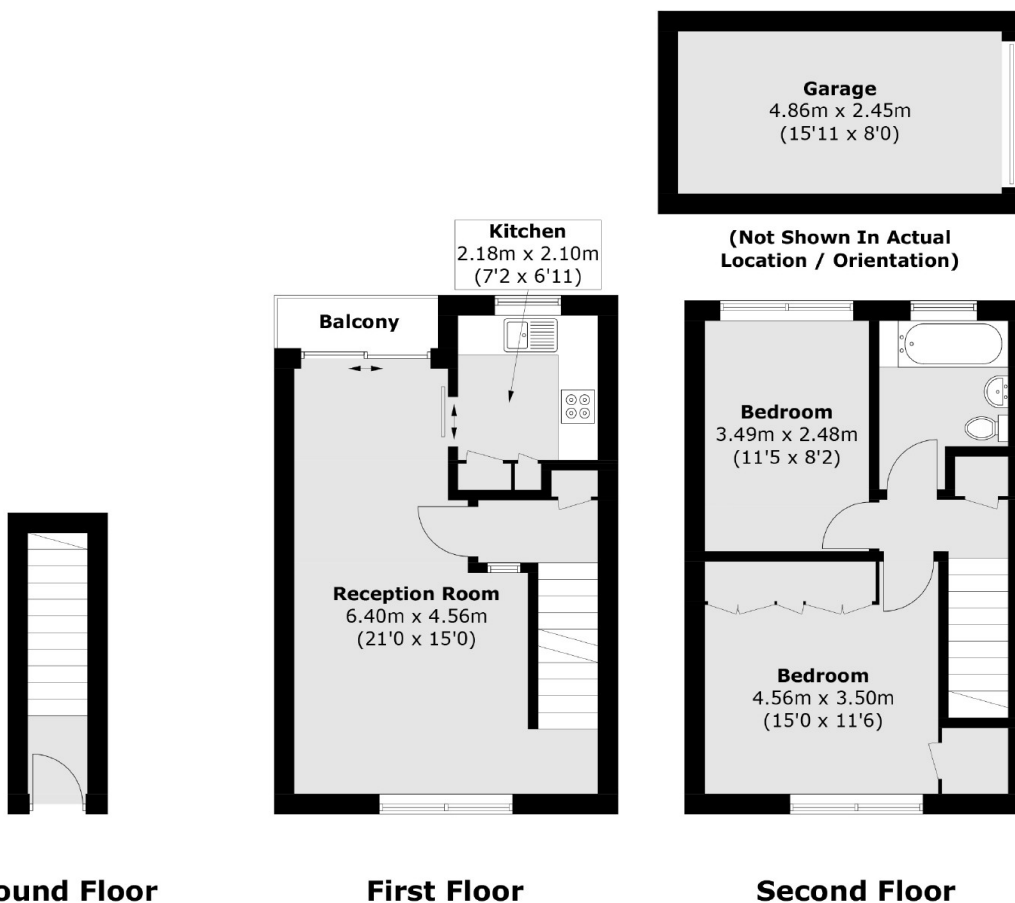

Total area (approx.): 67.4 sq. m (725.4 sq. ft)
Garage: 11.9 sq. m (128.1 sq. ft)
Balcony: 1.8 sq. m (19.4 sq. ft)