



## Waldegrave Road, W5

£385,000

A one bedroom ground floor flat located on this quiet cul-de-sac close to Ealing Broadway and Ealing Common. The property has a private garden and offers a great opportunity for both first time buyers and investors looking to be close to transport and move straight in with no work required.

Waldegrave Road is located within walking distance of three stations with access to the Elizabeth, Central, District and Piccadilly lines. There is easy access to the A40 and M4 via the North Circular and the green space of Ealing Common is a short walk.

### Features

- One Bedroom Flat
- Close to Stations
- Share of Freehold
- Private Garden
- Separate Garage
- No Modernisation Required

# Waldegrave Road, London, W5

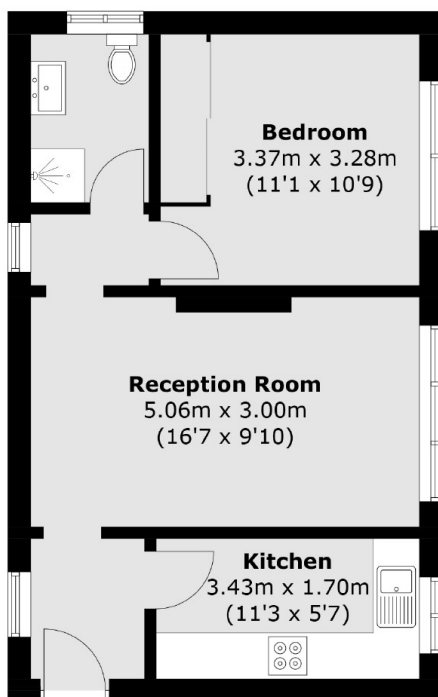

**Ground Floor**

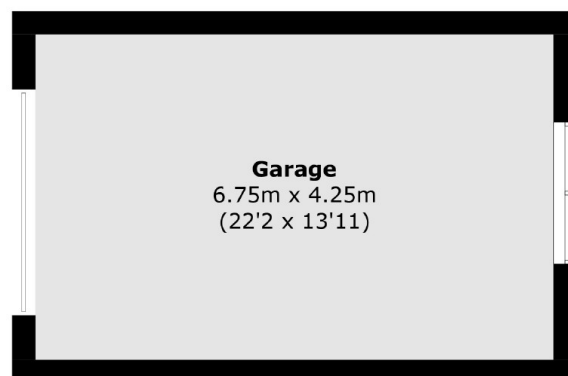

**(Not Shown In Actual  
Location / Orientation)**

Approx Internal Area: 42.7 sq. m (459.6 sq. ft)  
Garage: 28.7 sq. m (308.9 sq. ft)