



Madeley Road, W5

£550,000

This three bedroom top floor period conversion is offered with no onward chain and benefits from nearly 1000sq.ft of living space. The property would benefit from light refurbishment/modernisation and presents a fantastic opportunity for a large apartment near a new Elizabeth Line station.

Located on Madeley Road, around the corner from Ealing Broadway station with the new Elizabeth line, District and Central lines along with national rail services. All the shops, restaurants and amenities you could need are on your doorstep.

Features

- Three Bedrooms
- Large Reception Room
- Top Floor
- Period Conversion
- No Onward Chain
- Close To Transport

Madeley Road, London, W5

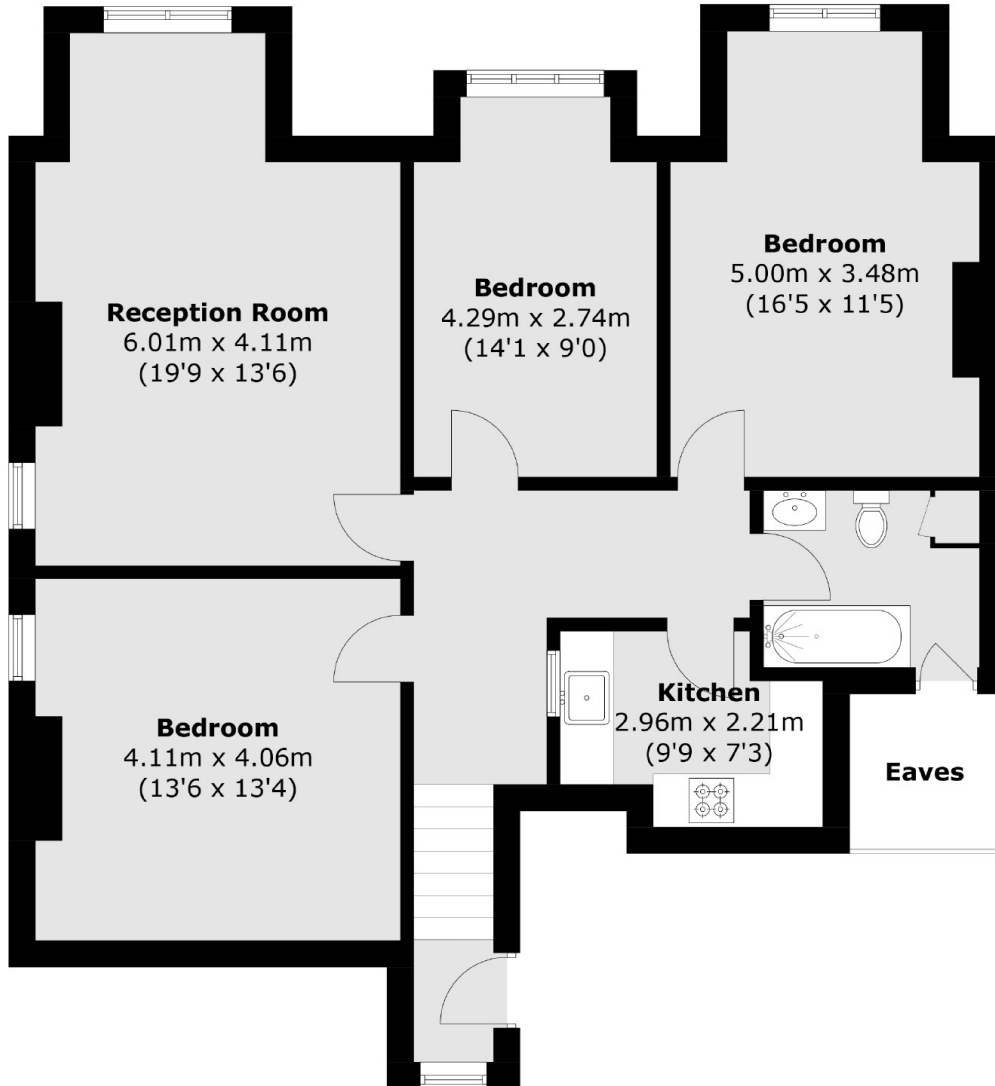

Total area (approx.): 91.5 sq. m (984.9 sq. ft)
(Excluding Eaves)