



Corfton Road, W5

£425,000

Located just 0.4 miles from Ealing Broadway, this property on Corfton Road offers a blend of convenience and comfort in one of West London's most desirable areas. With a share of the freehold, you'll enjoy a greater degree of ownership and flexibility compared to standard leasehold properties.

Excellent transport links via Ealing Broadway, including access to the Elizabeth Line, Central Line, and District Line, along with a range of local amenities such as shops, restaurants, and parks. In addition, there are easy routes out of London via the A40.

Features

Two Bedrooms
Close to Ealing Broadway
Top Floor
Double Glazed
Chain Free

Corfton Road,
London, W5

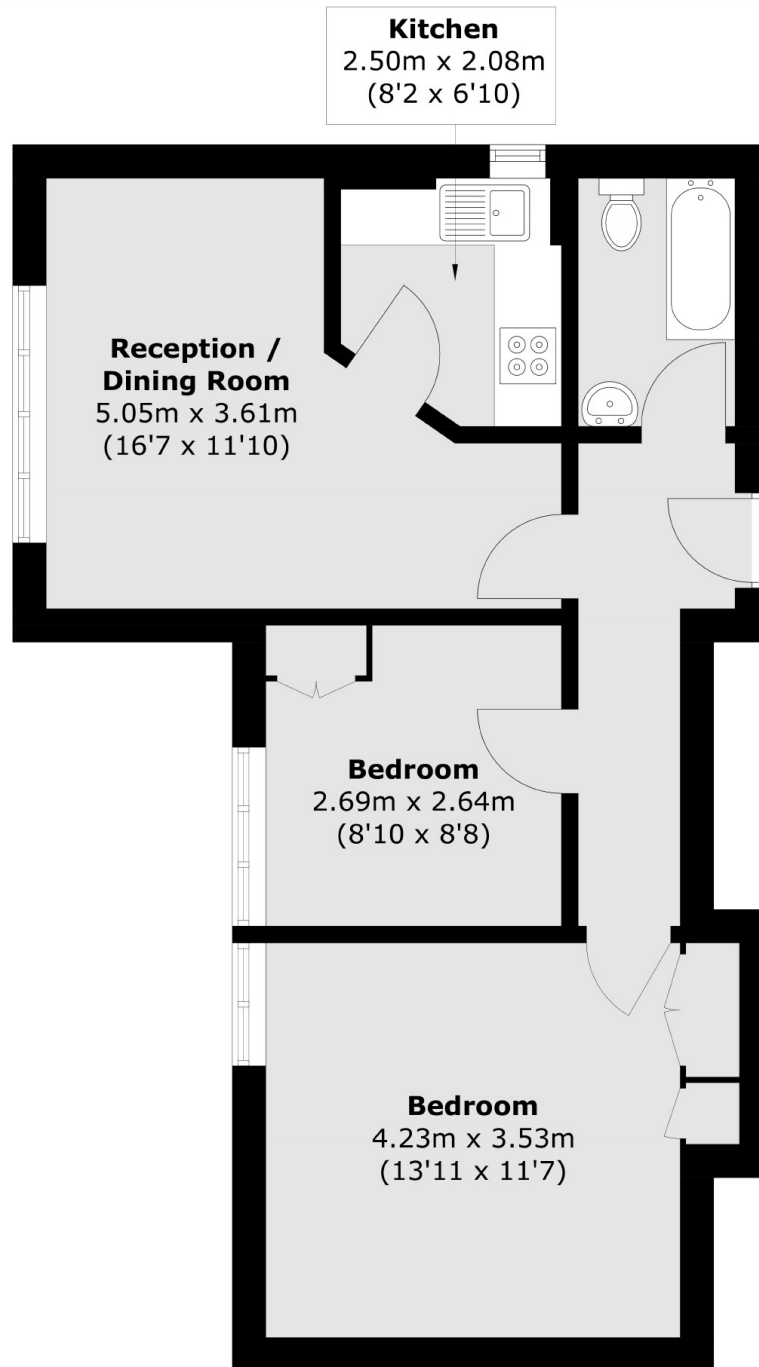

Total area (approx.): 48.9 sq. m (526.3 sq. ft)