



The Grove, W5 £449,000

A spacious two bedroom ground floor period conversion in excellent condition throughout and with direct access to a communal garden. This property has a share of freehold and no onward chain.

The Grove is less than half a mile from Ealing Broadway station with its wide range of transport links, including the Elizabeth Line, Central and District lines. Just moments from the green space of Ealing Common and Ealing Broadway Shopping Centre.

Features

- Two Bedrooms
- Ground Floor
- Residents Parking
- Share Of Freehold
- Central Location
- Communal Garden

The Grove,
London, W5

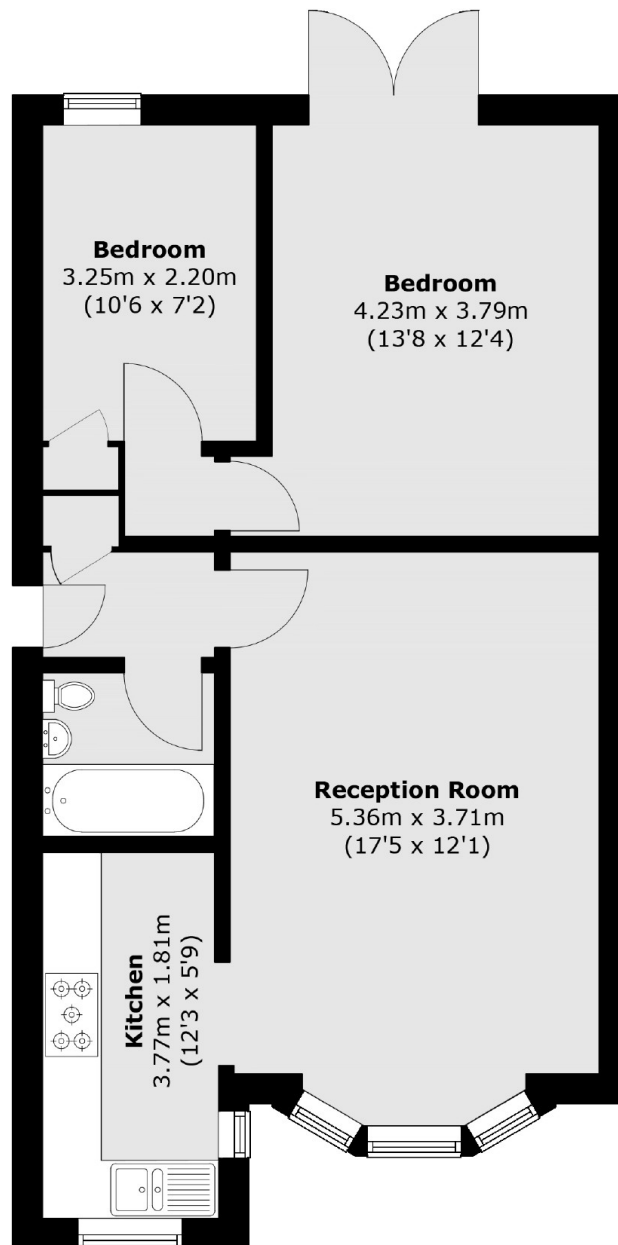

Total area (approx.): 59.3 sq. m (638.2 sq. ft)